

Specifications

Nominal Voltage		12 V
Capacity (25°C)	10HR(10.8V)	95 Ah
	5HR(10.5V)	83Ah
	1HR(9.60V)	58Ah
Dimension	Length	306mm ± 2 (12.05inch)
	Width	169mm ± 2 (6.65inch)
	Height	211mm ± 2 (8.31inch)
	Total Height	T5: 233 ± 2mm (9.17inch)
T9: 214 ± 2mm (8.43inch)		
Approx. Weight		27.5kg (60.6lbs) ± 4%
Terminal type		T5/T9
Internal resistance (Fully charged, 25°C)		Approx. 5m Ω
Capacity affected by temperature (10HR)	40°C	102%
	25°C	100%
	0°C	85%
	-15°C	65%
Self-discharge (25°C)	3 month	Remaining Capacity: 91%
	6 month	Remaining Capacity: 82%
	12 month	Remaining Capacity: 65%
Nominal operating temperature		25°C ± 3°C (77°F ± 5°F)
Operating temperature range	Discharge	-15°C ~ 50°C (5°F ~ 122°F)
	Charge	-10°C ~ 50°C (14°F ~ 122°F)
	Storage	-20°C ~ 50°C (-4°F ~ 122°F)
Float charging voltage(25°C)		13.50 to 13.80V Temperature compensation: -18mV/°C
Cyclic charging voltage(25°C)		14.50 to 14.90V Temperature compensation: -30mV/°C
Maximum charging current		28.5A
Terminal material		Copper
Maximum discharge current		800A(5 sec.)
Designed floating life(20°C)		12 years

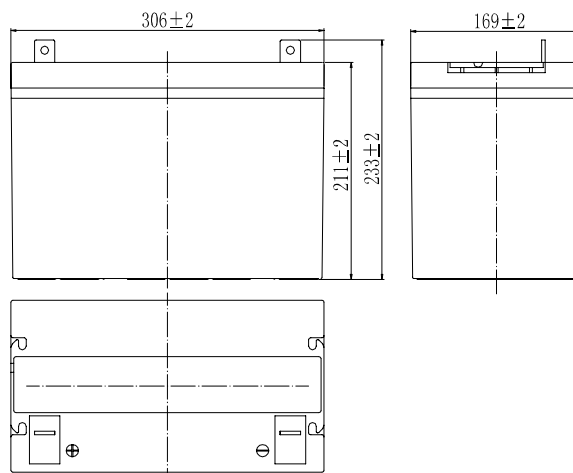

Dimensions



Terminal

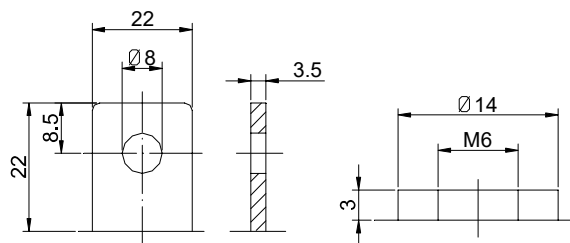

Terminal T5

Terminal T9

- ◆ Absorbent glass mat technology;
- ◆ Recognized by UL & CE;
- ◆ ABS container.

Constant Current Discharge Characteristics (A, 25°C)

F.V/TIME	10min	15min	30min	60min	2h	3h	4h	5h	8h	10h	20h
9.60V	200	157	95.0	58.9	34.7	24.2	19.9	17.0	11.6	9.67	5.08
9.90V	194	153	93.1	58.0	34.5	24.1	19.7	16.9	11.6	9.65	5.07
10.2V	186	147	90.3	56.5	34.2	23.9	19.6	16.7	11.5	9.62	5.05
10.5V	178	142	88.1	55.4	33.7	23.8	19.5	16.6	11.4	9.57	5.02
10.8V	168	135	84.8	53.7	32.8	23.0	18.9	16.1	11.1	9.50	4.99

Constant Power Discharge Characteristics (Watt, 25°C)

F.V/TIME	10min	15min	30min	60min	2h	3h	4h	5h	8h	10h	20h
9.60V	2155	1721	1066	671	402	285	234	200	138	115	60.9
9.90V	2090	1680	1045	661	400	283	232	199	137	115	60.8
10.2V	2004	1618	1013	645	396	281	231	198	136	115	60.6
10.5V	1918	1563	988	632	390	279	229	197	135	114	60.3
10.8V	1810	1480	952	612	380	271	222	191	131	113	59.9

Note: The above characteristics data can be obtained within three charge/discharge cycles.

Discharge Characteristics(25°C)

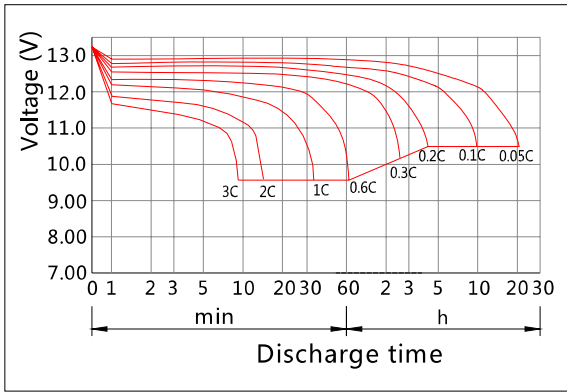

Charging Characteristics(25°C)

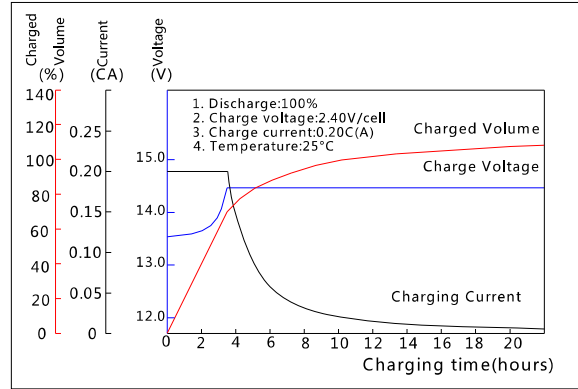

Effect of Temperature on Capacity

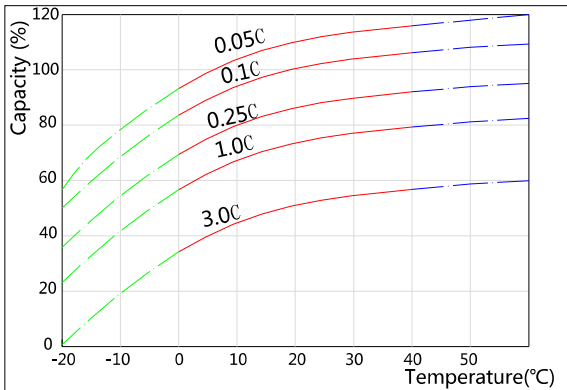

Self-discharge Characteristics

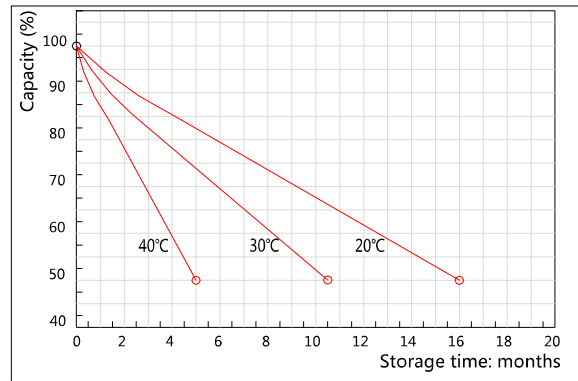

The Relationship for Open Circuit Voltage and Residual Capacity (25°C)

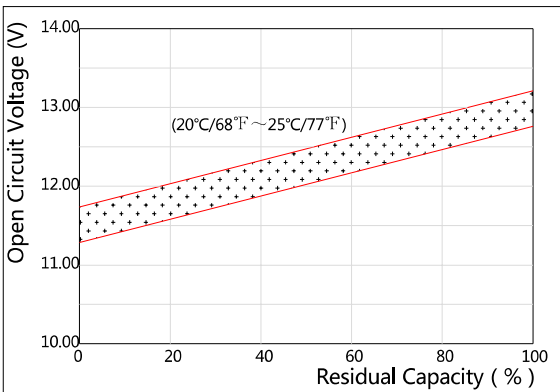

The Relationship for Charging Voltage and Temperature

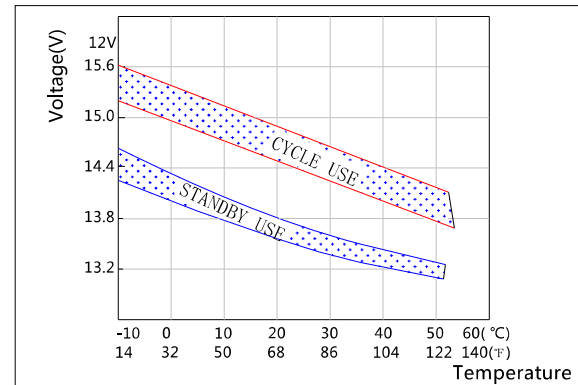

Floating Life on Temperature

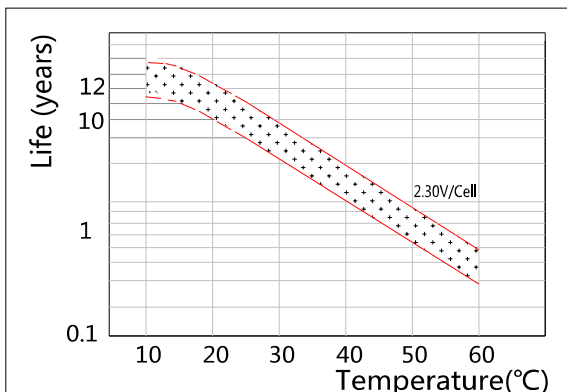

Cycle Life on D.O.D(25°C)

