

Specifications

| | | |
|---|--------------|---|
| Nominal Voltage | | 12 V |
| Capacity (25°C) | 10HR(10.8V) | 90 Ah |
| | 5HR(10.5V) | 79Ah |
| | 1HR(9.60V) | 55.8Ah |
| Dimension | Length | 306mm ± 2 (12.05inch) |
| | Width | 169mm ± 2 (6.65inch) |
| | Height | 211mm ± 2 (8.31inch) |
| | Total Height | T5: 233 ± 2mm (9.17inch) T9: 214 ± 2mm (8.43inch) |
| Approx. Weight | | 28.5kg (62.8lbs) ± 4% |
| Terminal type | | T5/T9 |
| Internal resistance (Fully charged, 25°C) | | Approx. 5.5m Ω |
| Capacity affected by temperature (10HR) | 40°C | 102% |
| | 25°C | 100% |
| | 0°C | 85% |
| | -15°C | 65% |
| Self-discharge (25°C) | 3 month | Remaining Capacity: 91% |
| | 6 month | Remaining Capacity: 82% |
| | 12 month | Remaining Capacity: 65% |
| Nominal operating temperature | | 25°C ± 3°C (77°F ± 5°F) |
| Operating temperature range | Discharge | -15°C ~ 50°C (5°F ~ 122°F) |
| | Charge | -10°C ~ 50°C (14°F ~ 122°F) |
| | Storage | -20°C ~ 50°C (-4°F ~ 122°F) |
| Float charging voltage(25°C) | | 13.50 to 13.80V Temperature compensation: -18mV/°C |
| Cyclic charging voltage(25°C) | | 14.50 to 14.90V Temperature compensation: -30mV/°C |
| Maximum charging current | | 27A |
| Terminal material | | Copper |
| Maximum discharge current | | 800A(5 sec.) |
| Designed floating life(20°C) | | 15 years |

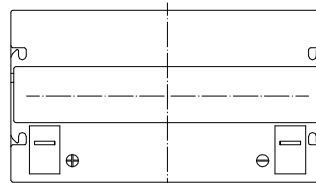

Dimensions

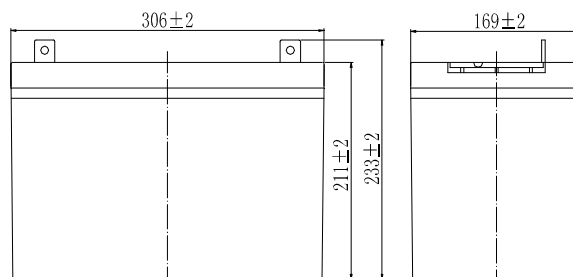

Terminal

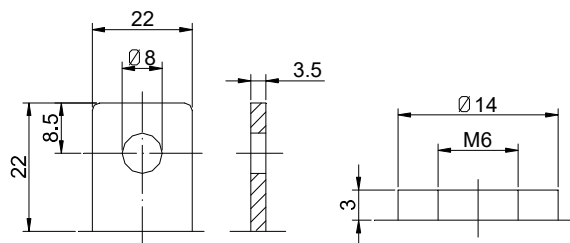

Terminal T5

Terminal T9

- ◆ Absorbent glass mat technology;
- ◆ Recognized by UL & CE;
- ◆ ABS container.

Constant Current Discharge Characteristics (A, 25°C)

| F.V/TIME | 10min | 15min | 30min | 60min | 2h | 3h | 4h | 5h | 8h | 10h | 20h |
|----------|-------|-------|-------|-------|------|------|------|------|------|------|------|
| 9.60V | 183 | 146 | 88.2 | 55.8 | 32.9 | 23.0 | 18.8 | 16.1 | 11.0 | 9.16 | 4.81 |
| 9.90V | 178 | 142 | 86.4 | 55.0 | 32.7 | 22.8 | 18.7 | 16.0 | 11.0 | 9.14 | 4.80 |
| 10.2V | 170 | 137 | 83.8 | 53.6 | 32.4 | 22.7 | 18.6 | 15.9 | 10.9 | 9.12 | 4.79 |
| 10.5V | 163 | 132 | 81.8 | 52.5 | 31.9 | 22.5 | 18.5 | 15.8 | 10.8 | 9.06 | 4.76 |
| 10.8V | 154 | 125 | 78.8 | 50.9 | 31.1 | 21.8 | 17.9 | 15.3 | 10.5 | 9.00 | 4.73 |

Constant Power Discharge Characteristics (Watt, 25°C)

| F.V/TIME | 10min | 15min | 30min | 60min | 2h | 3h | 4h | 5h | 8h | 10h | 20h |
|----------|-------|-------|-------|-------|-----|-----|-----|-----|-----|-----|------|
| 9.60V | 1980 | 1598 | 990 | 636 | 381 | 270 | 221 | 190 | 131 | 109 | 57.7 |
| 9.90V | 1921 | 1560 | 970 | 627 | 379 | 268 | 220 | 189 | 130 | 109 | 57.6 |
| 10.2V | 1841 | 1502 | 940 | 611 | 375 | 266 | 218 | 187 | 129 | 109 | 57.4 |
| 10.5V | 1762 | 1451 | 917 | 599 | 370 | 265 | 217 | 186 | 128 | 108 | 57.1 |
| 10.8V | 1663 | 1374 | 884 | 580 | 360 | 257 | 210 | 181 | 124 | 107 | 56.7 |

Note: The above characteristics data can be obtained within three charge/discharge cycles.

Discharge Characteristics(25°C)

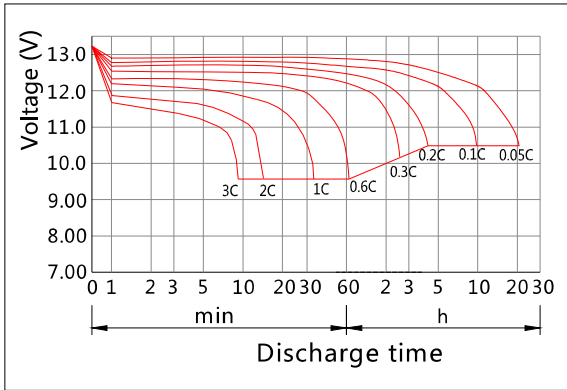

Charging Characteristics(25°C)

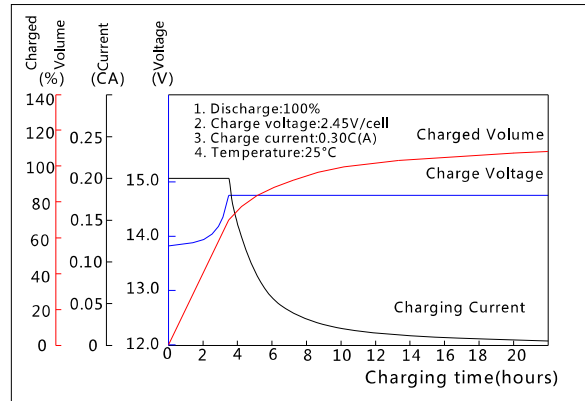

Effect of Temperature on Capacity

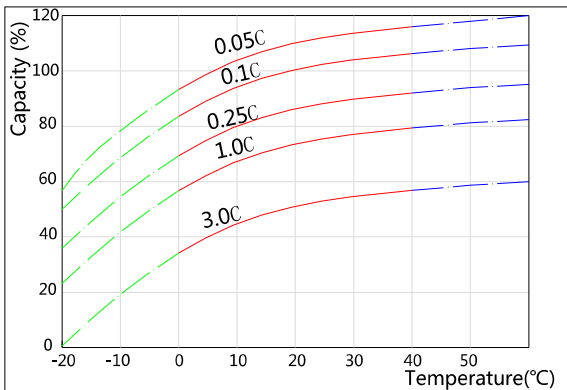

Self-discharge Characteristics

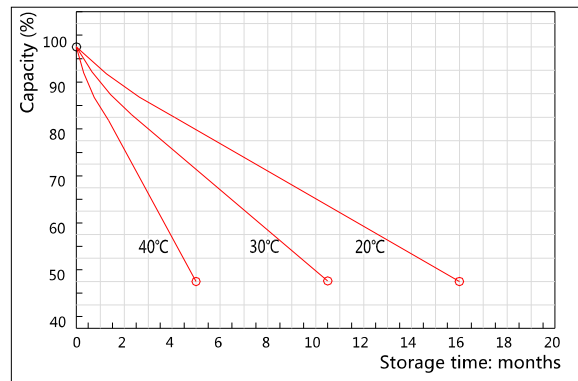

The Relationship for Open Circuit Voltage and Residual Capacity (25°C)

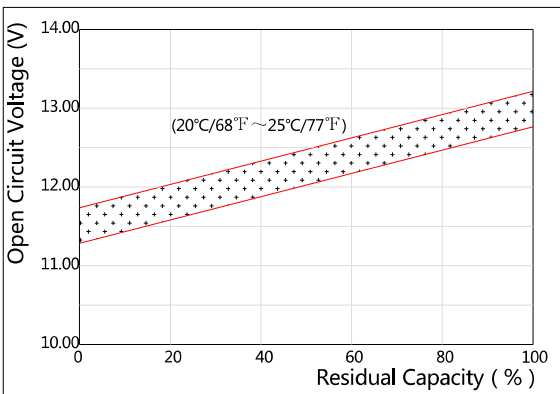

The Relationship for Charging Voltage and Temperature

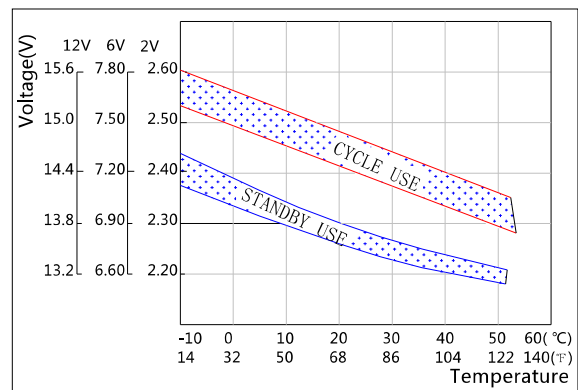

Floating Life on Temperature

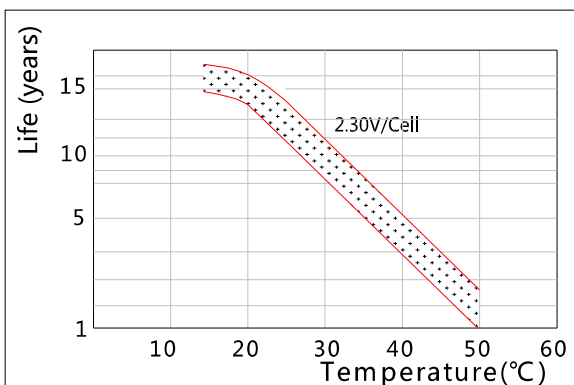

Cycle Life on D.O.D(25°C)

