

Specifications

| | | |
|---|--------------|---|
| Nominal Voltage | | 12 V |
| Capacity (25°C) | 10HR(10.8V) | 34 Ah |
| | 5HR(10.5V) | 29.7Ah |
| | 1HR(9.60V) | 21.1Ah |
| Dimension | Length | 310 ± 2mm (12.2inch) |
| | Width | 77 ± 1mm (3.03inch) |
| | Height | 166 ± 2mm (6.54inch) |
| | Total Height | T2: 172 ± 2mm (6.77inch) T3: 180 ± 2mm (7.09inch) |
| Approx. Weight | | 9.5kg (20.9lbs) ± 4% |
| Terminal type | | T2/T3 |
| Internal resistance (Fully charged, 25°C) | | Approx. 11m Ω |
| Capacity affected by temperature (10HR) | 40°C | 102% |
| | 25°C | 100% |
| | 0°C | 85% |
| | -15°C | 65% |
| Self-discharge (25°C) | 3 month | Remaining Capacity: 91% |
| | 6 month | Remaining Capacity: 82% |
| | 12 month | Remaining Capacity: 65% |
| Nominal operating temperature | | 25°C ± 3°C (77°F ± 5°F) |
| Operating temperature range | Discharge | -15°C ~ 50°C (5°F ~ 122°F) |
| | Charge | -10°C ~ 50°C (14°F ~ 122°F) |
| | Storage | -20°C ~ 50°C (-4°F ~ 122°F) |
| Float charging voltage(25°C) | | 13.50 to 13.80V Temperature compensation: -18mV/°C |
| Cyclic charging voltage(25°C) | | 14.50 to 14.90V Temperature compensation: -30mV/°C |
| Maximum charging current | | 10.2A |
| Terminal material | | Copper |
| Maximum discharge current | | 200A(5 sec.) |
| Designed floating life(20°C) | | 12 years |

- ◆ Absorbent glass mat technology;
- ◆ Recognized by UL & CE;
- ◆ ABS container.

Constant Current Discharge Characteristics (A, 25°C)

| F.V/TIME | 15min | 30min | 60min | 2h | 3h | 4h | 5h | 6h | 8h | 10h | 20h |
|----------|-------|-------|-------|------|------|------|------|------|------|------|------|
| 9.60V | --- | 34.0 | 21.1 | 12.4 | 8.67 | 7.11 | 6.07 | 5.31 | 4.16 | 3.46 | 1.82 |
| 9.90V | --- | 33.3 | 20.8 | 12.4 | 8.62 | 7.07 | 6.03 | 5.27 | 4.14 | 3.45 | 1.81 |
| 10.2V | --- | 32.3 | 20.2 | 12.2 | 8.56 | 7.02 | 5.99 | 5.24 | 4.11 | 3.44 | 1.81 |
| 10.5V | --- | 31.5 | 19.8 | 12.1 | 8.50 | 6.97 | 5.95 | 5.20 | 4.08 | 3.42 | 1.80 |
| 10.8V | --- | 30.4 | 19.2 | 11.8 | 8.25 | 6.76 | 5.77 | 5.05 | 3.96 | 3.40 | 1.79 |

Constant Power Discharge Characteristics (Watt, 25°C)

| F.V/TIME | 15min | 30min | 60min | 2h | 3h | 4h | 5h | 6h | 8h | 10h | 20h |
|----------|-------|-------|-------|-----|------|------|------|------|------|------|------|
| 9.60V | --- | 381 | 240 | 144 | 102 | 83.6 | 71.7 | 62.7 | 49.4 | 41.3 | 21.8 |
| 9.90V | --- | 374 | 237 | 143 | 101 | 83.1 | 71.3 | 62.3 | 49.1 | 41.2 | 21.8 |
| 10.2V | --- | 362 | 231 | 142 | 101 | 82.5 | 70.8 | 61.9 | 48.8 | 41.1 | 21.7 |
| 10.5V | --- | 354 | 226 | 140 | 100 | 82.0 | 70.3 | 61.5 | 48.5 | 40.9 | 21.6 |
| 10.8V | --- | 341 | 219 | 136 | 97.0 | 79.5 | 68.2 | 59.6 | 47.0 | 40.6 | 21.4 |

Note: The above characteristics data can be obtained within three charge/discharge cycles.



Dimensions

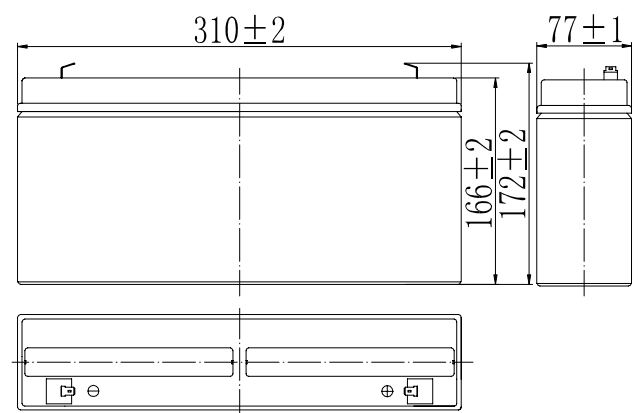

Terminal

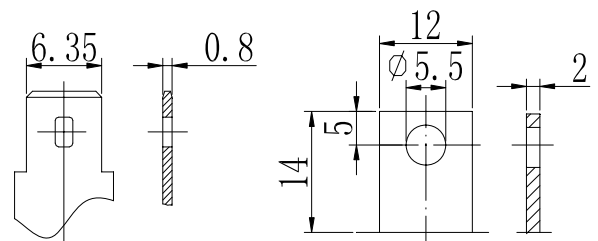

Terminal T2

Terminal T3

Discharge Characteristics(25°C)

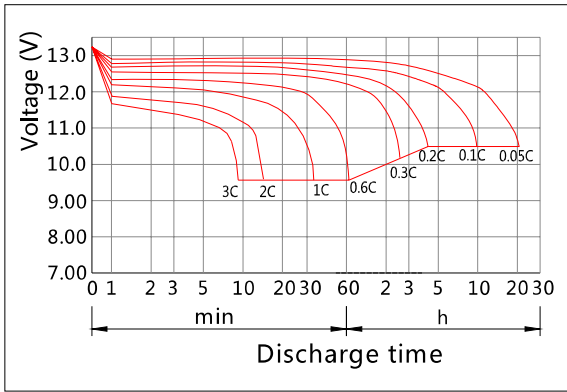

Charging Characteristics(25°C)

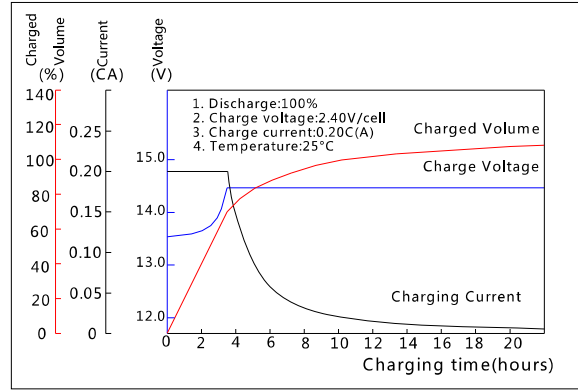

Effect of Temperature on Capacity

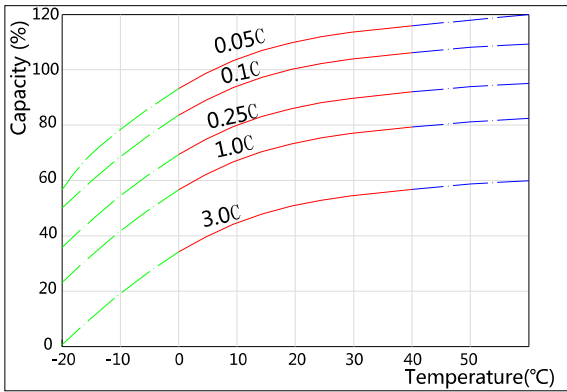

Self-discharge Characteristics

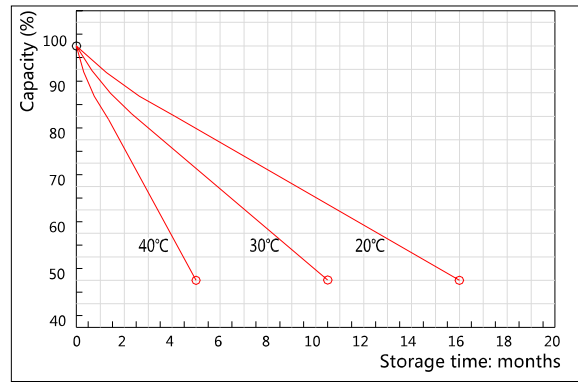

The Relationship for Open Circuit Voltage and Residual Capacity (25°C)

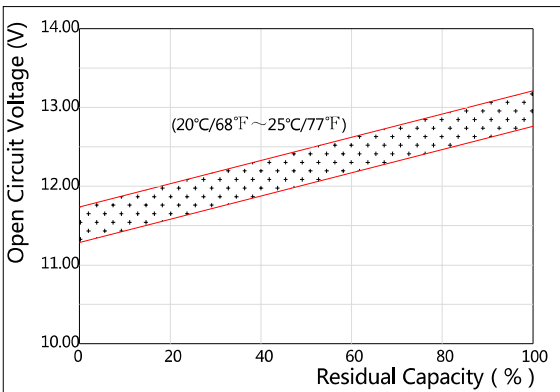

The Relationship for Charging Voltage and Temperature

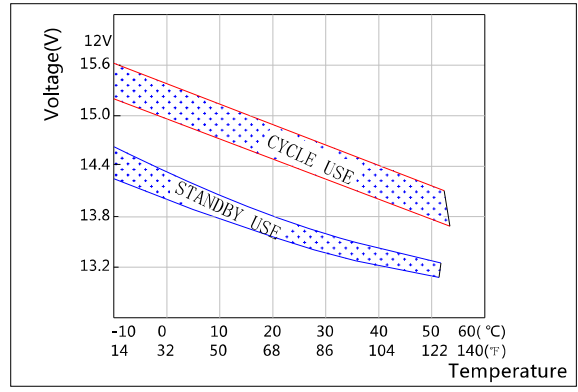

Floating Life on Temperature

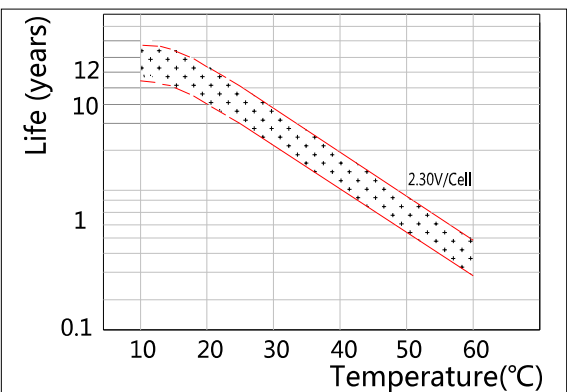

Cycle Life on D.O.D(25°C)

