

Specifications

Nominal Voltage		12 V
Capacity (25°C)	10HR(10.8V)	230 Ah
	5HR(10.5V)	201Ah
	1HR(9.60V)	143Ah
Dimension	Length	521 ± 2mm (20.51inch)
	Width	269 ± 2mm (10.59inch)
	Height	203 ± 2mm (7.99inch)
	Total Height	T5: 223 ± 2mm (8.78inch) T11: 206 ± 2mm (8.11inch)
Approx. Weight		66.5kg (146.6lbs) ± 3%
Terminal type		T5/T11
Internal resistance (Fully charged, 25°C)		Approx. 2.8m Ω
Capacity affected by temperature (10HR)	40°C	102%
	25°C	100%
	0°C	85%
	-15°C	65%
Self-discharge (25°C)	3 month	Remaining Capacity: 91%
	6 month	Remaining Capacity: 82%
	12 month	Remaining Capacity: 65%
Nominal operating temperature		25°C ± 3°C (77°F ± 5°F)
Operating temperature range	Discharge	-15°C ~ 50°C (5°F ~ 122°F)
	Charge	-10°C ~ 50°C (14°F ~ 122°F)
	Storage	-20°C ~ 50°C (-4°F ~ 122°F)
Float charging voltage(25°C)		13.50 to 13.80V Temperature compensation: -18mV/°C
Cyclic charging voltage(25°C)		14.50 to 14.90V Temperature compensation: -30mV/°C
Maximum charging current		69A
Terminal material		Copper
Maximum discharge current		1700A(5 sec.)
Designed floating life(20°C)		12 years

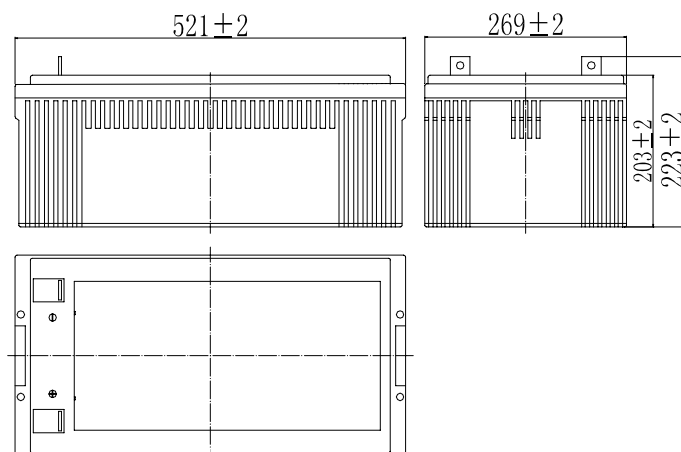

Dimensions



Terminal

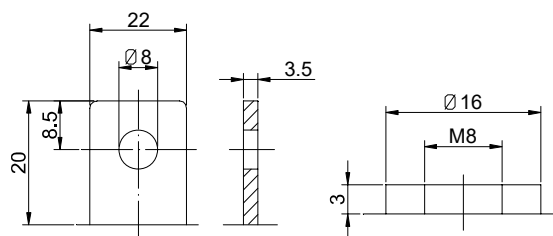

Terminal T5

Terminal T11

- ◆ Absorbent glass mat technology;
- ◆ Recognized by UL & CE;
- ◆ ABS container.

Constant Current Discharge Characteristics (A, 25°C)

F.V/TIME	15min	30min	60min	2h	3h	4h	5h	6h	8h	10h	20h
9.60V	380	230	143	84.0	58.7	48.1	41.1	35.9	28.2	23.4	12.3
9.90V	370	225	140	83.5	58.3	47.8	40.8	35.7	28.0	23.4	12.3
10.2V	357	219	137	82.8	57.9	47.5	40.5	35.4	27.8	23.3	12.2
10.5V	345	213	134	81.6	57.5	47.2	40.3	35.2	27.6	23.2	12.2
10.8V	326	205	130	79.5	55.8	45.7	39.0	34.1	26.8	23.0	12.1

Constant Power Discharge Characteristics (Watt, 25°C)

F.V/TIME	15min	30min	60min	2h	3h	4h	5h	6h	8h	10h	20h
9.60V	4167	2581	1626	973	690	566	485	424	334	280	148
9.90V	4067	2529	1601	967	686	562	482	422	332	279	147
10.2V	3917	2452	1561	959	681	558	479	419	330	278	147
10.5V	3784	2392	1530	944	676	554	476	416	328	277	146
10.8V	3584	2304	1483	920	656	538	461	403	318	275	145

Note: The above characteristics data can be obtained within three charge/discharge cycles.

Discharge Characteristics(25°C)

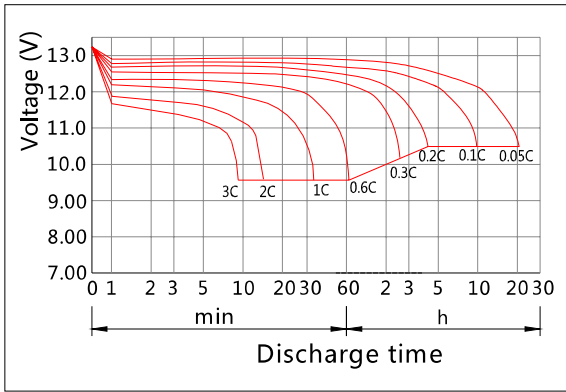

Charging Characteristics(25°C)

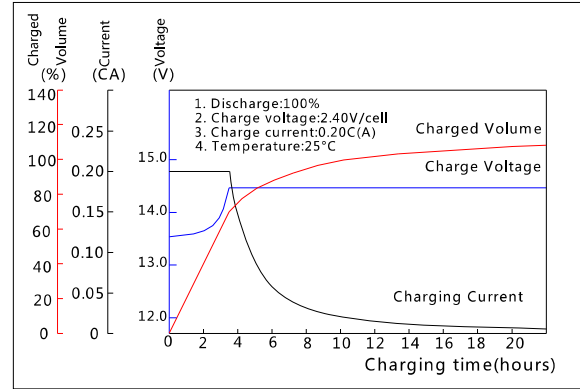

Effect of Temperature on Capacity

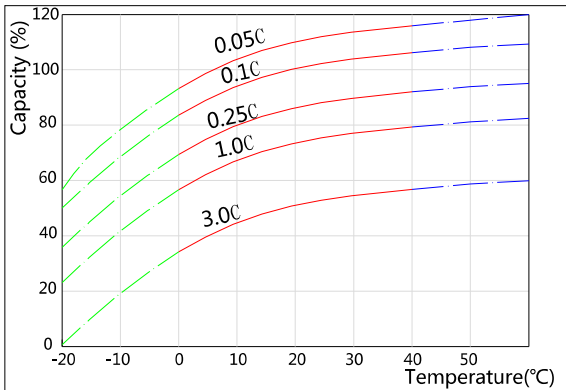

Self-discharge Characteristics

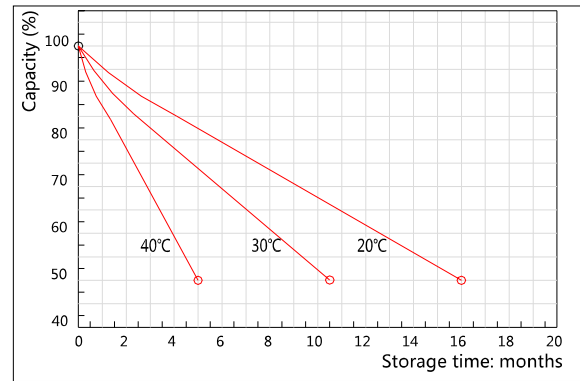

The Relationship for Open Circuit Voltage and Residual Capacity (25°C)

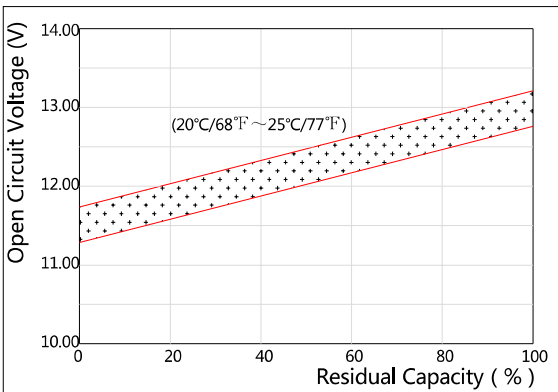

The Relationship for Charging Voltage and Temperature

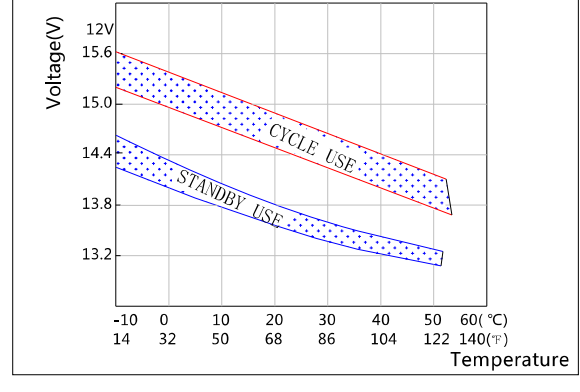

Floating Life on Temperature

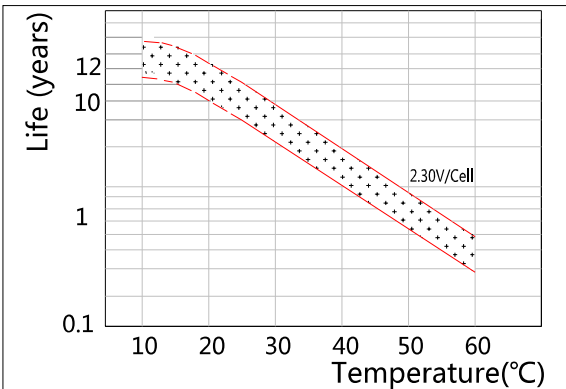

Cycle Life on D.O.D(25°C)

