

**Specifications**

Nominal Voltage		12 V
Capacity (25°C)	10HR(10.8V)	225 Ah
	5HR(10.5V)	197Ah
	1HR(9.60V)	140Ah
Dimension	Length	522 ± 2mm (20.55inch)
	Width	238 ± 2mm (9.37inch)
	Height	218 ± 2mm (8.58inch)
	Total Height	T5: 238 ± 2mm (9.37inch) T11: 221 ± 2mm (8.70inch)
Approx. Weight		65kg (143.3lbs) ± 3%
Terminal type		T5/T11
Internal resistance (Fully charged, 25°C)		Approx. 2.8m Ω
Capacity affected by temperature (10HR)	40°C	102%
	25°C	100%
	0°C	85%
	-15°C	65%
Self-discharge (25°C)	3 month	Remaining Capacity: 91%
	6 month	Remaining Capacity: 82%
	12 month	Remaining Capacity: 65%
Nominal operating temperature		25°C ± 3°C (77°F ± 5°F)
Operating temperature range	Discharge	-15°C ~ 50°C (5°F ~ 122°F)
	Charge	-10°C ~ 50°C (14°F ~ 122°F)
	Storage	-20°C ~ 50°C (-4°F ~ 122°F)
Float charging voltage(25°C)		13.50 to 13.80V Temperature compensation: -18mV/°C
Cyclic charging voltage(25°C)		14.50 to 14.90V Temperature compensation: -30mV/°C
Maximum charging current		67.5A
Terminal material		Copper
Maximum discharge current		1600A(5 sec.)
Designed floating life(20°C)		12 years

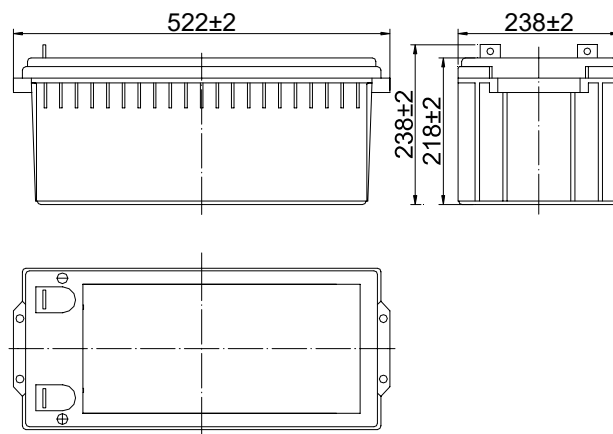

**Dimensions**



**Terminal**

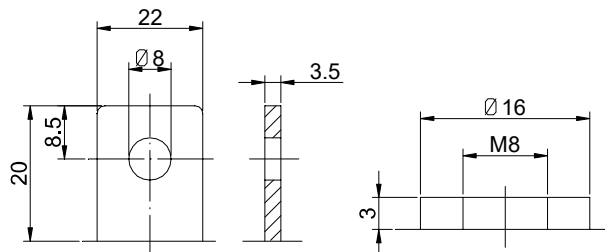

Terminal T5

Terminal T11

- ◆ Absorbent glass mat technology;
- ◆ Recognized by UL & CE;
- ◆ ABS container.

**Constant Current Discharge Characteristics (A, 25°C)**

F.V/TIME	15min	30min	60min	2h	3h	4h	5h	6h	8h	10h	20h
9.60V	371	225	140	82.2	57.4	47.0	40.2	35.1	27.5	22.9	12.0
9.90V	362	221	137	81.7	57.0	46.8	39.9	34.9	27.4	22.9	12.0
10.2V	349	214	134	81.0	56.6	46.4	39.7	34.7	27.2	22.8	12.0
10.5V	337	209	131	79.8	56.3	46.1	39.4	34.4	27.0	22.7	11.9
10.8V	319	201	127	77.8	54.6	44.7	38.2	33.4	26.2	22.5	11.8

**Constant Power Discharge Characteristics (Watt, 25°C)**

F.V/TIME	15min	30min	60min	2h	3h	4h	5h	6h	8h	10h	20h
9.60V	4101	2525	1590	952	675	553	475	415	327	273	144
9.90V	4003	2474	1566	946	671	550	472	413	325	273	144
10.2V	3855	2398	1527	938	666	546	469	410	323	272	144
10.5V	3724	2340	1496	924	662	542	465	407	321	271	143
10.8V	3527	2254	1450	900	642	526	451	395	311	269	142

Note: The above characteristics data can be obtained within three charge/discharge cycles.

**Discharge Characteristics(25°C)**

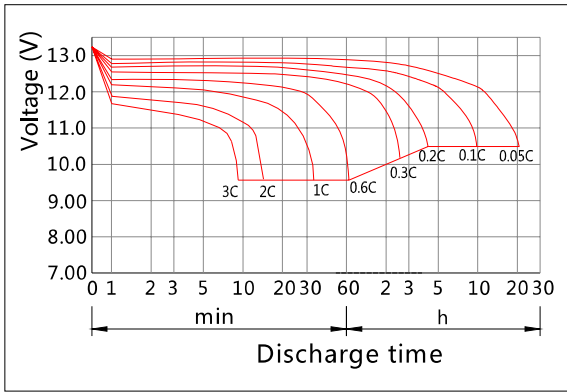

**Charging Characteristics(25°C)**

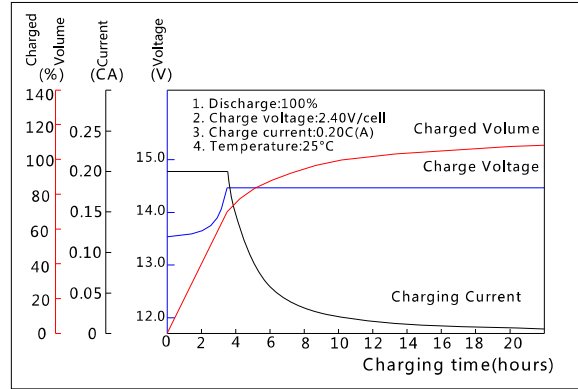

**Effect of Temperature on Capacity**

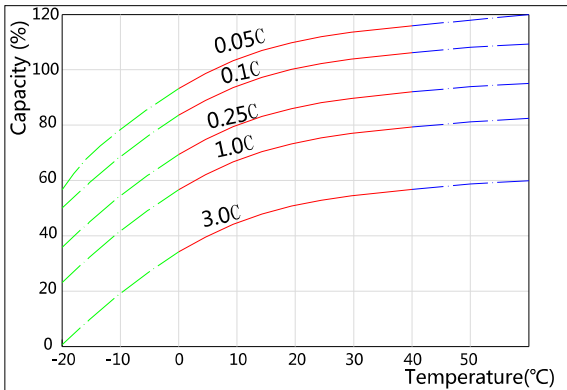

**Self-discharge Characteristics**

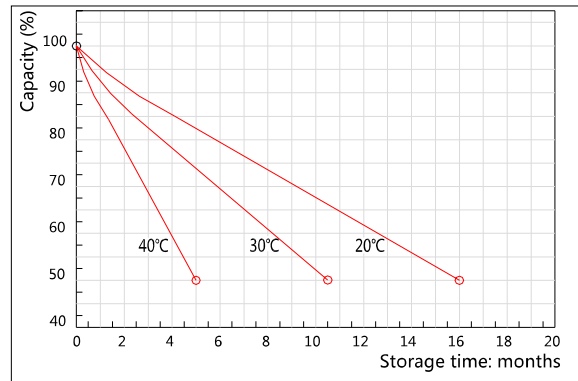

**The Relationship for Open Circuit Voltage and Residual Capacity (25°C)**

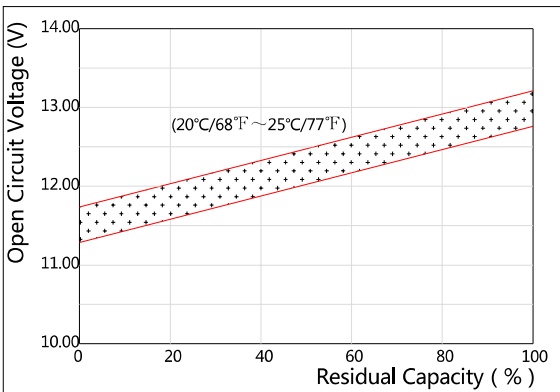

**The Relationship for Charging Voltage and Temperature**

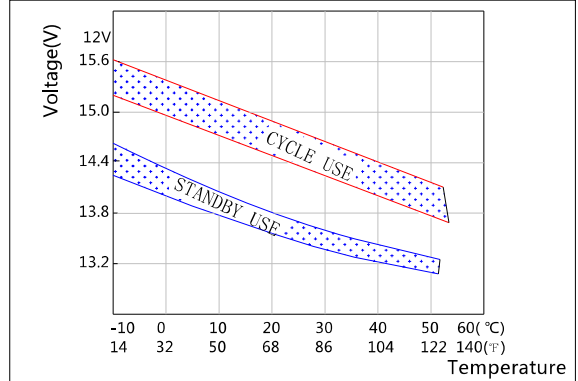

**Floating Life on Temperature**

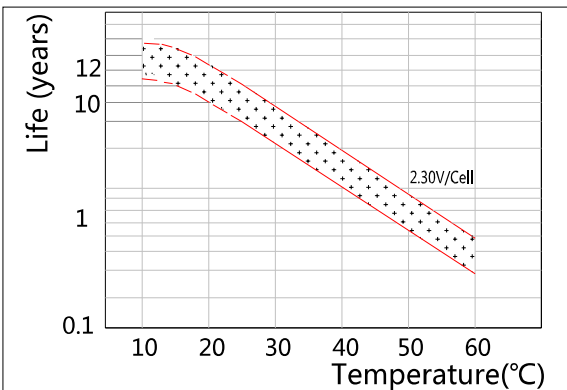

**Cycle Life on D.O.D(25°C)**

