

**Specifications**

Nominal Voltage		12 V
Capacity (25°C)	10HR(10.8V)	160Ah
	5HR(10.5V)	140Ah
	1HR(9.60V)	99.2Ah
Dimension	Length	485 ± 2mm (19.09inch)
	Width	172 ± 2mm (6.77inch)
	Height	240 ± 2mm (9.45inch)
	Total Height	T5: 242 ± 2mm (9.53inch) T11: 240 ± 2mm (9.45inch)
Approx. Weight		47kg (103.6lbs) ± 4%
Terminal type		T5/T11
Internal resistance (Fully charged, 25°C)		Approx. 3.2m Ω
Capacity affected by temperature (10HR)	40°C	102%
	25°C	100%
	0°C	85%
	-15°C	65%
Self-discharge (25°C)	3 month	Remaining Capacity: 91%
	6 month	Remaining Capacity: 82%
	12 month	Remaining Capacity: 65%
Nominal operating temperature		25°C ± 3°C (77°F ± 5°F)
Operating temperature range	Discharge	-15°C ~ 50°C (5°F ~ 122°F)
	Charge	-10°C ~ 50°C (14°F ~ 122°F)
	Storage	-20°C ~ 50°C (-4°F ~ 122°F)
Float charging voltage(25°C)		13.50 to 13.80V Temperature compensation: -18mV/°C
Cyclic charging voltage(25°C)		14.50 to 14.90V Temperature compensation: -30mV/°C
Maximum charging current		49.5A
Terminal material		Copper
Maximum discharge current		1210A(5 sec.)
Designed floating life(20°C)		10~12 years

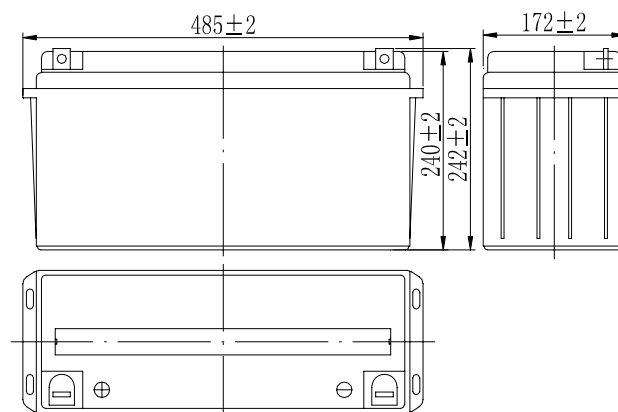

**Dimensions**



**Terminal**

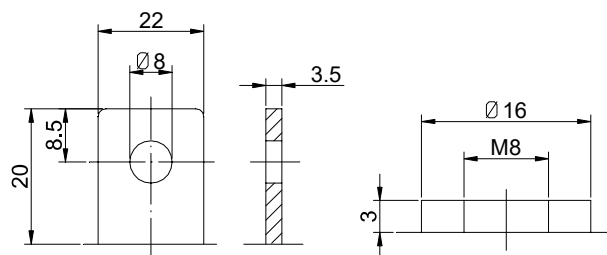

Terminal T5

Terminal T11

- ◆ Absorbent glass mat technology;
- ◆ Recognized by UL & CE;
- ◆ ABS container.

**Constant Current Discharge Characteristics (A, 25°C)**

F.V/TIME	15min	30min	60min	2h	3h	4h	5h	6h	8h	10h	20h
9.60V	264.0	160.0	99.2	58.5	40.8	33.5	28.6	25.0	19.6	16.3	8.55
9.90V	257.7	156.8	97.7	58.1	40.6	33.3	28.4	24.8	19.5	16.3	8.53
10.2V	248.2	152.0	95.2	57.6	40.3	33.0	28.2	24.7	19.3	16.2	8.51
10.5V	239.7	148.3	93.3	56.7	40.0	32.8	28.0	24.5	19.2	16.1	8.46
10.8V	227.0	142.9	90.5	55.3	38.8	31.8	27.2	23.7	18.6	16.0	8.40

**Constant Power Discharge Characteristics (Watt, 25°C)**

F.V/TIME	15min	30min	60min	2h	3h	4h	5h	6h	8h	10h	20h
9.60V	2899	1795	1131	677	480	393	338	295	233	194	102.6
9.90V	2829	1759	1114	673	477	391	336	293	231	194	102.4
10.2V	2725	1705	1086	667	474	388	333	291	230	194	102.1
10.5V	2632	1664	1064	657	470	386	331	289	228	192	101.5
10.8V	2493	1603	1031	640	456	374	321	281	221	191	100.8

Note: The above characteristics data can be obtained within three charge/discharge cycles.

Discharge Characteristics(25°C)

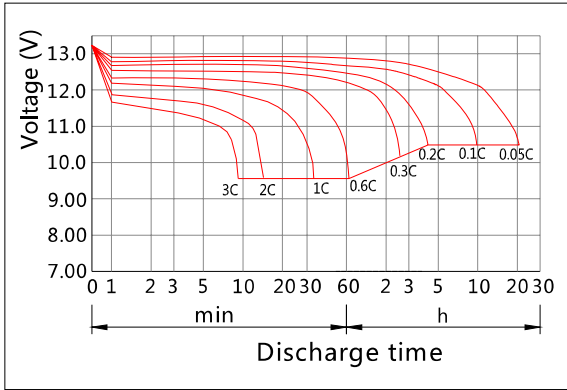

Charging Characteristics(25°C)

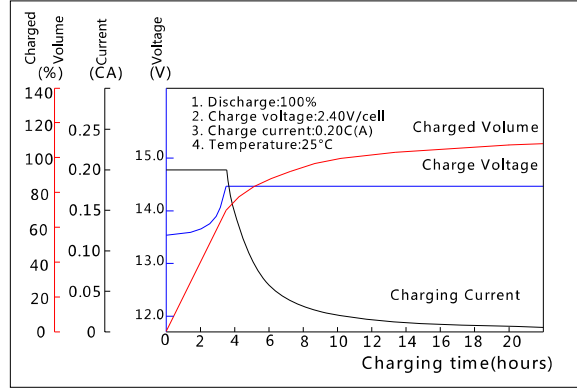

Effect of Temperature on Capacity

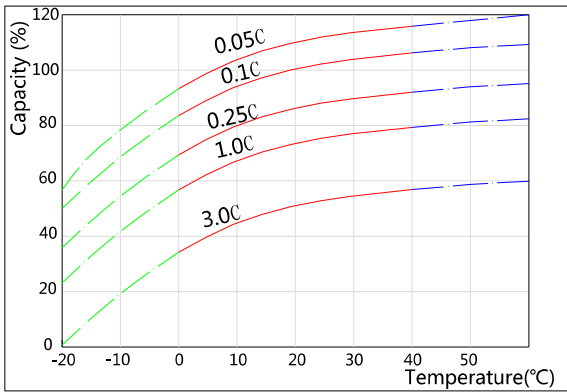

Self-discharge Characteristics

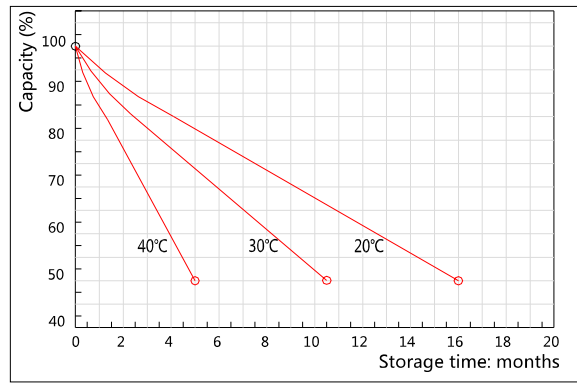

The Relationship for Open Circuit Voltage and Residual Capacity (25°C)

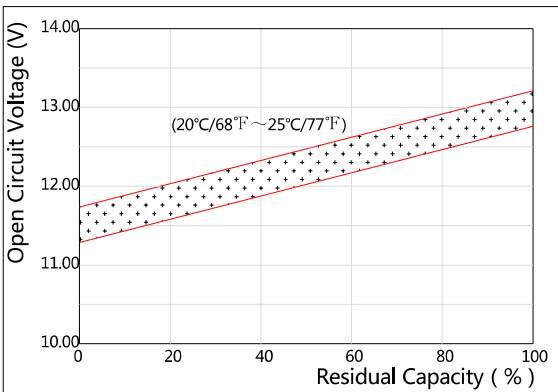

The Relationship for Charging Voltage and Temperature

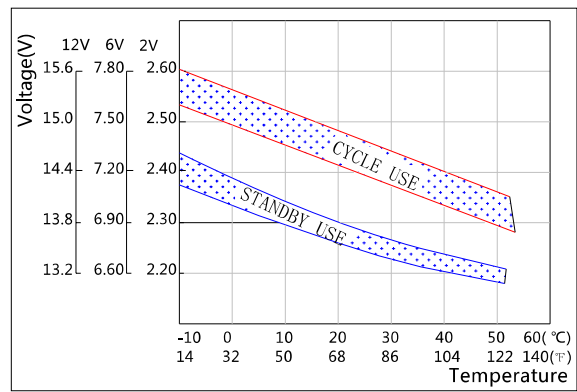

Floating Life on Temperature

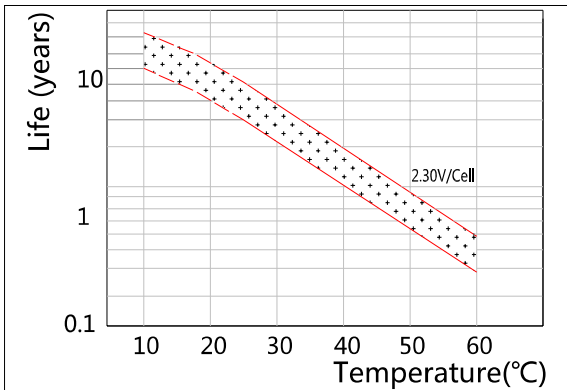

Cycle Life on D.O.D(25°C)

