

Specifications

Nominal Voltage		12 V
Capacity (25°C)	10HR(10.8V)	110 Ah
	5HR(10.5V)	96.5Ah
	1HR(9.60V)	71.3Ah
Dimension	Length	330 ± 2mm (12.99inch)
	Width	171 ± 2mm (6.73inch)
	Height	214 ± 2mm (8.43inch)
	Total Height	T5: 224 ± 2mm (8.82inch) T9: 220 ± 2mm (8.66inch)
Approx. Weight		32.5kg (71.7lbs) ± 4%
Terminal type		T5/T9
Internal resistance (Fully charged, 25°C)		Approx. 3.5m Ω
Capacity affected by temperature (10HR)	40°C	102%
	25°C	100%
	0°C	85%
	-15°C	65%
Self-discharge (25°C)	3 month	Remaining Capacity: 91%
	6 month	Remaining Capacity: 82%
	12 month	Remaining Capacity: 65%
Nominal operating temperature		25°C ± 3°C (77°F ± 5°F)
Operating temperature range	Discharge	-15°C ~ 50°C (5°F ~ 122°F)
	Charge	-10°C ~ 50°C (14°F ~ 122°F)
	Storage	-20°C ~ 50°C (-4°F ~ 122°F)
Float charging voltage(25°C)		13.50 to 13.80V Temperature compensation: -18mV/°C
Cyclic charging voltage(25°C)		14.50 to 14.90V Temperature compensation: -30mV/°C
Maximum charging current		36A
Terminal material		Copper
Maximum discharge current		880A(5 sec.)
Designed floating life(20°C)		12 years

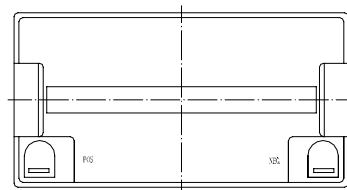

Dimensions

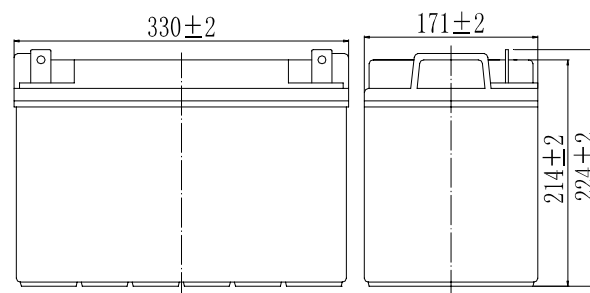

Terminal

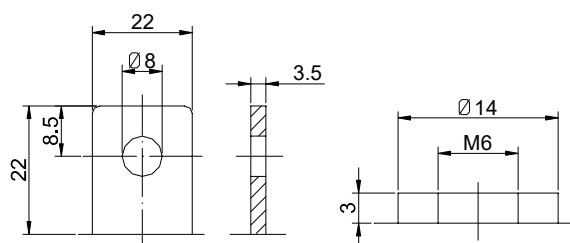

Terminal T5

Terminal T9

- ◆ Absorbent glass mat technology;
- ◆ Recognized by UL & CE;
- ◆ ABS container.

Constant Current Discharge Characteristics (A, 25°C)

F.V/TIME	15min	30min	60min	2h	3h	4h	5h	6h	8h	10h	20h
9.60V	190	115	71.3	40.2	28.1	23.0	19.6	17.2	13.5	11.2	5.88
9.90V	185	113	70.2	40.0	27.9	22.9	19.5	17.1	13.4	11.2	5.87
10.2V	178	109	68.4	39.6	27.7	22.7	19.4	16.9	13.3	11.1	5.85
10.5V	172	107	67.1	39.0	27.5	22.6	19.3	16.8	13.2	11.1	5.82
10.8V	163	103	65.0	38.0	26.7	21.9	18.7	16.3	12.8	11.0	5.78

Constant Power Discharge Characteristics (Watt, 25°C)

F.V/TIME	15min	30min	60min	2h	3h	4h	5h	6h	8h	10h	20h
9.60V	2083	1290	813	465	330	270	232	203	160	134	70.5
9.90V	2033	1264	801	463	328	269	231	202	159	133	70.4
10.2V	1958	1226	780	459	326	267	229	200	158	133	70.2
10.5V	1892	1196	765	452	323	265	228	199	157	132	69.8
10.8V	1792	1152	741	440	314	257	221	193	152	131	69.3

Note: The above characteristics data can be obtained within three charge/discharge cycles.

Discharge Characteristics(25°C)

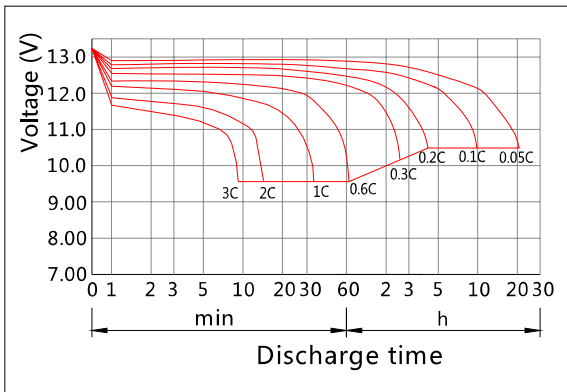

Charging Characteristics(25°C)

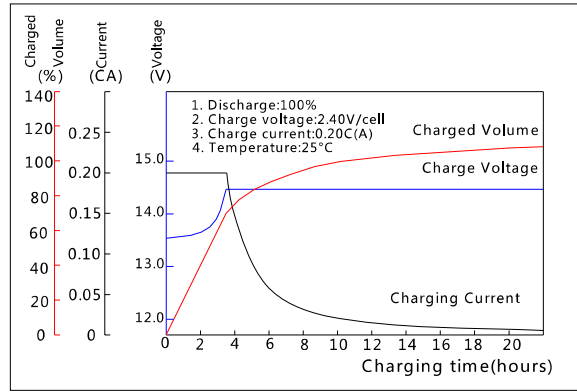

Effect of Temperature on Capacity

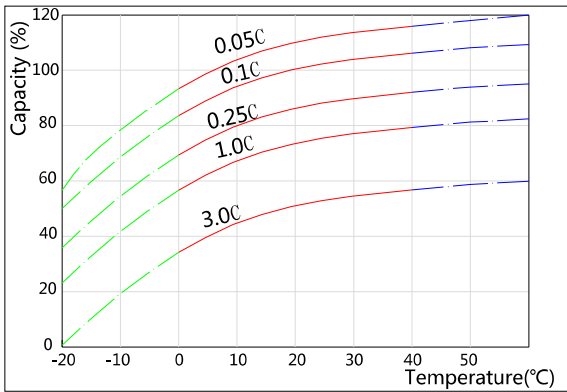

Self-discharge Characteristics

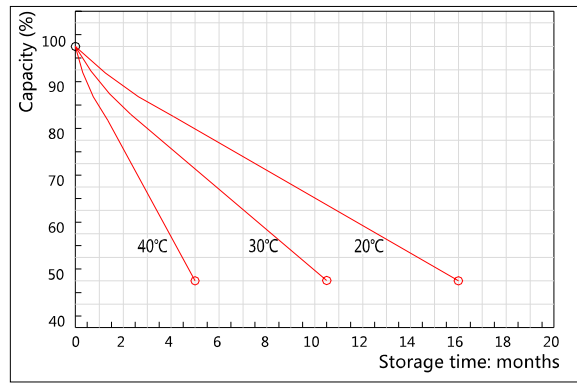

The Relationship for Open Circuit Voltage and Residual Capacity (25°C)

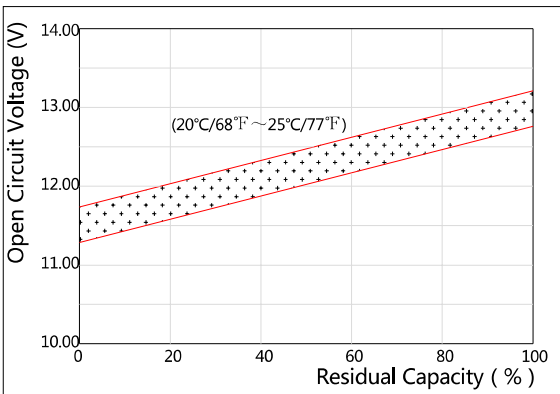

The Relationship for Charging Voltage and Temperature

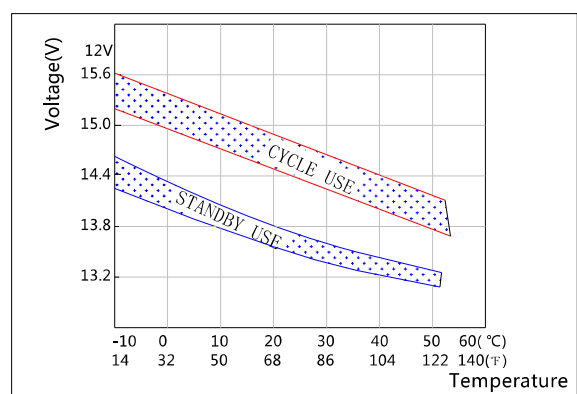

Floating Life on Temperature

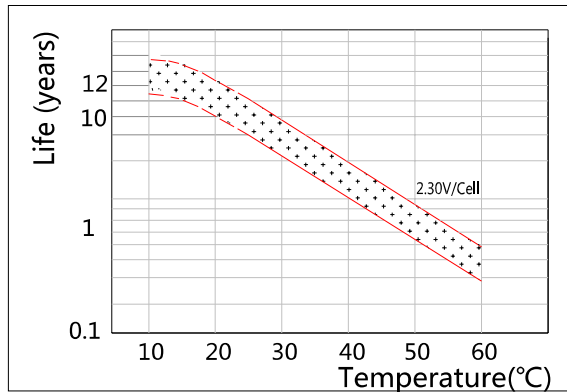

Cycle Life on D.O.D(25°C)

