

Specifications

Nominal Voltage		12 V
Capacity (25 °C)	20HR(10.5V)	6.5Ah
	10HR(10.5V)	6Ah
	1HR(9.60V)	4.23Ah
Dimension	Length	151 ± 1.5mm (5.94inch)
	Width	65 ± 1mm (2.56inch)
	Height	94 ± 1mm (3.70inch)
	Total Height	100 ± 1mm (3.94inch)
Approx. Weight		2.02kg (4.46lbs) ± 5%
Terminal type		T1/T2
Internal resistance (Fully charged, 25 °C)		Approx. 30m Ω
Capacity affected by temperature (20HR)	40 °C	102%
	25 °C	100%
	0 °C	85%
	-15 °C	65%
Self-discharge (25 °C)	3 month	Remaining Capacity: 91%
	6 month	Remaining Capacity: 82%
	12 month	Remaining Capacity: 65%
Nominal operating temperature		25 °C ± 3 °C (77 °F ± 5 °F)
Operating temperature range	Discharge	-15 °C ~ 50 °C (5 °F ~ 122 °F)
	Charge	-10 °C ~ 50 °C (14 °F ~ 122 °F)
	Storage	-20 °C ~ 50 °C (-4 °F ~ 122 °F)
Float charging voltage(25 °C)		13.60 to 13.80V Temperature compensation: -18mV/°C
Cyclic charging voltage(25 °C)		14.50 to 14.90V Temperature compensation: -30mV/°C
Maximum charging current		1.95A
Terminal material		Copper
Maximum discharge current		97.5A (5 sec.)
Designed floating life(20 °C)		10years

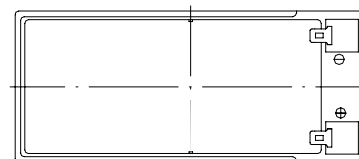

Dimensions

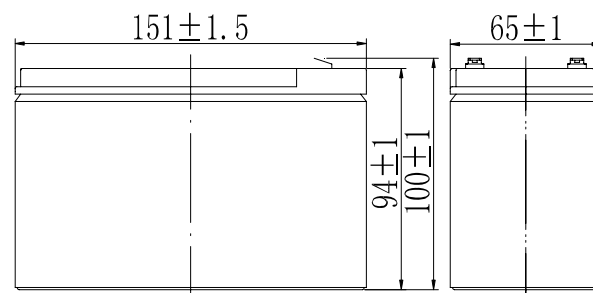

Terminal

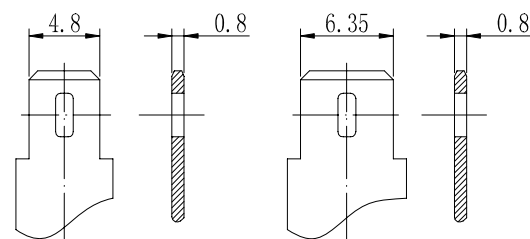

Terminal T1

Terminal T2

- ◆ Absorbent glass mat technology;
- ◆ Recognized by UL & CE;
- ◆ ABS container.

Constant Current Discharge Characteristics (A, 25 °C)

F.V/TIME	5min	10min	15min	30min	60min	2h	3h	4h	5h	10h	20h
9.60V	24.7	15.6	12.4	6.89	4.23	2.31	1.66	1.33	1.13	0.61	0.330
9.90V	24.0	15.1	12.1	6.75	4.16	2.30	1.65	1.32	1.12	0.61	0.329
10.2V	23.0	14.5	11.6	6.55	4.06	2.28	1.64	1.31	1.11	0.61	0.327
10.5V	22.0	13.9	11.2	6.39	3.98	2.24	1.63	1.30	1.11	0.60	0.325
10.8V	20.7	13.1	10.6	6.15	3.85	2.18	1.58	1.26	1.07	0.59	0.319

Constant Power Discharge Characteristics (Watt, 25 °C)

F.V/TIME	5min	10min	15min	30min	60min	2h	3h	4h	5h	10h	20h
9.60V	276	176	141	79.0	48.9	27.0	19.7	15.8	13.5	7.36	3.96
9.90V	267	171	137	77.4	48.2	26.9	19.6	15.7	13.4	7.33	3.94
10.2V	256	164	132	75.0	47.0	26.6	19.4	15.6	13.3	7.30	3.92
10.5V	245	157	128	73.2	46.0	26.2	19.3	15.5	13.2	7.25	3.90
10.8V	232	148	121	70.5	44.6	25.6	18.7	15.0	12.8	7.11	3.82

Note: The above characteristics data can be obtained within three charge/discharge cycles.

Discharge Characteristics(25°C)

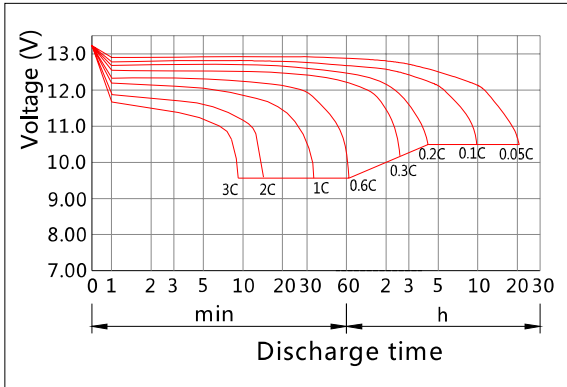

Charging Characteristics(25°C)

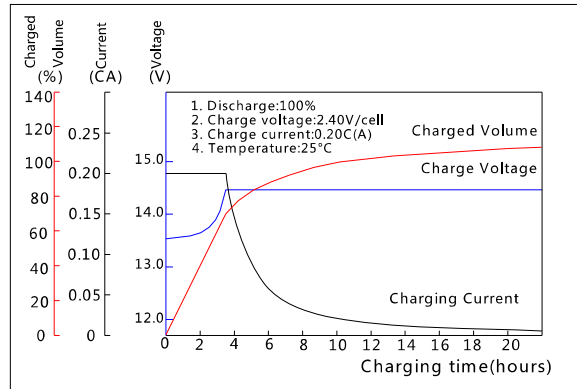

Effect of Temperature on Capacity

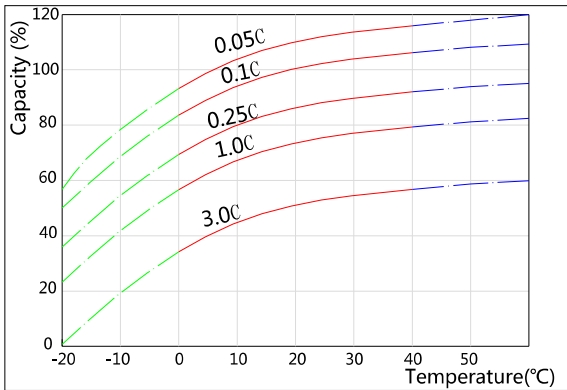

Self-discharge Characteristics

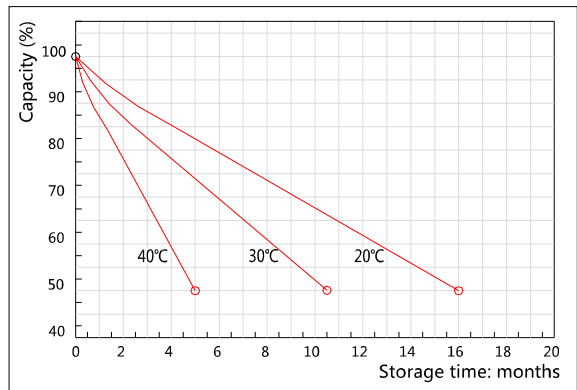

The Relationship for Open Circuit Voltage and Residual Capacity (25°C)

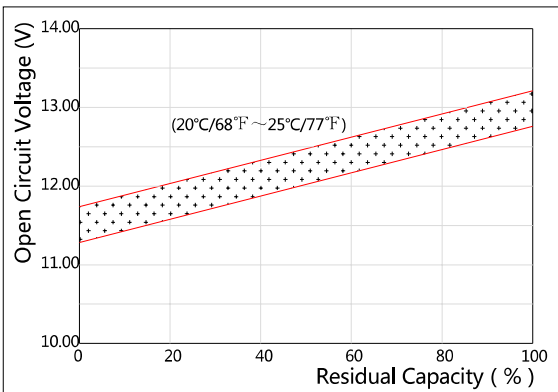

The Relationship for Charging Voltage and Temperature

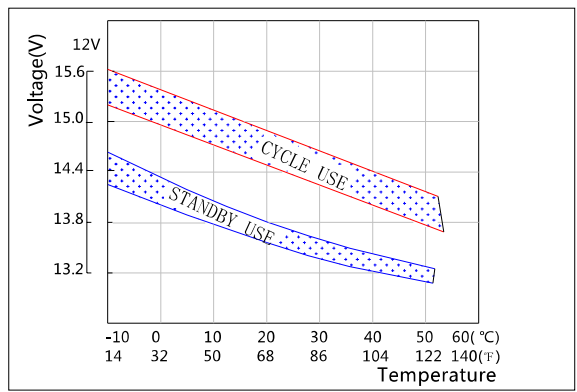

Floating Life on Temperature

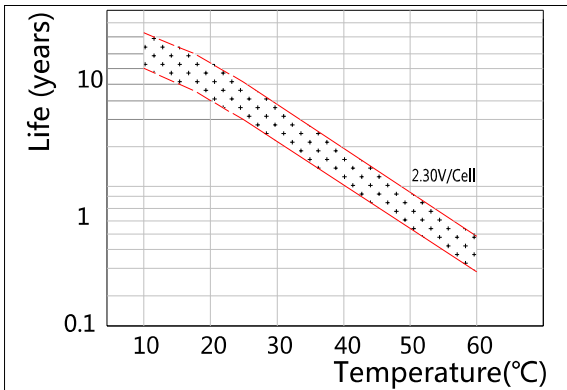

Cycle Life on D.O.D(25°C)

