

**Specifications**

Nominal Voltage		12 V
Capacity (25°C)	20HR(10.5V)	2.7Ah
	10HR(10.5V)	2.5Ah
	1HR(9.60V)	1.76Ah
Dimension	Length	104 ± 1mm (4.09inch)
	Width	48 ± 1mm (1.89inch)
	Height	70 ± 1mm (2.76inch)
	Total Height	70 ± 1mm (2.76inch)
Approx. Weight		0.98kg (2.16lbs) ± 5%
Terminal type		+T2/-T1
Internal resistance (Fully charged, 25°C)		Approx. 38m Ω
Capacity affected by temperature (20HR)	40°C	102%
	25°C	100%
	0°C	85%
	-15°C	65%
Self-discharge (25°C)	3 month	Remaining Capacity: 91%
	6 month	Remaining Capacity: 82%
	12 month	Remaining Capacity: 65%
Nominal operating temperature		25°C ± 3°C (77°F ± 5°F)
Operating temperature range	Discharge	-15°C ~ 50°C (5°F ~ 122°F)
	Charge	-10°C ~ 50°C (14°F ~ 122°F)
	Storage	-20°C ~ 50°C (-4°F ~ 122°F)
Float charging voltage(25°C)		13.60 to 13.80V Temperature compensation: -18mV/°C
Cyclic charging voltage(25°C)		14.50 to 14.90V Temperature compensation: -30mV/°C
Maximum charging current		0.81A
Terminal material		Copper
Maximum discharge current		40.5A(5 sec.)
Designed floating life(20°C)		10years

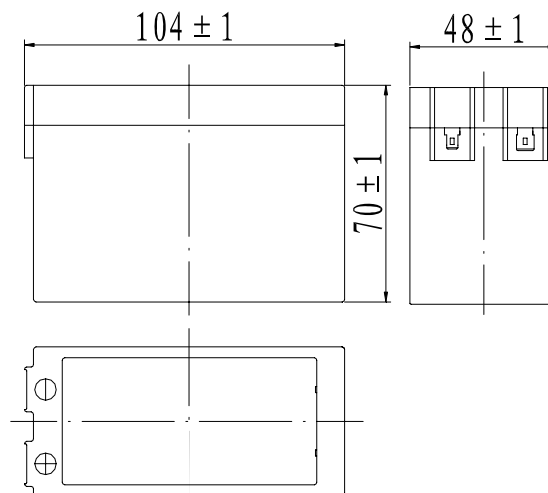

**Dimensions**



**Terminal**

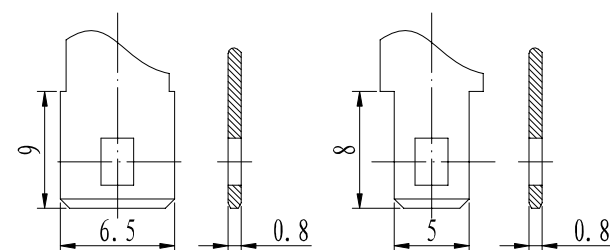

Positive terminal

Negative terminal

- ◆ Absorbent glass mat technology;
- ◆ Recognized by UL & CE;
- ◆ ABS container.

**Constant Current Discharge Characteristics (A, 25°C)**

F.V/TIME	5min	10min	15min	30min	60min	2h	3h	4h	5h	10h	20h
9.60V	10.3	6.48	5.13	2.86	1.76	0.96	0.69	0.55	0.47	0.25	0.137
9.90V	9.95	6.29	5.01	2.80	1.73	0.95	0.68	0.55	0.47	0.25	0.136
10.2V	9.54	6.03	4.82	2.72	1.68	0.95	0.68	0.54	0.46	0.25	0.136
10.5V	9.13	5.77	4.66	2.65	1.65	0.93	0.68	0.54	0.46	0.25	0.135
10.8V	8.62	5.44	4.41	2.56	1.60	0.91	0.65	0.52	0.45	0.25	0.132

**Constant Power Discharge Characteristics (Watt, 25°C)**

F.V/TIME	5min	10min	15min	30min	60min	2h	3h	4h	5h	10h	20h
9.60V	115	73.1	58.5	32.8	20.3	11.2	8.18	6.56	5.59	3.06	1.64
9.90V	111	70.9	57.1	32.1	20.0	11.2	8.13	6.52	5.56	3.05	1.64
10.2V	106	68.0	55.0	31.2	19.5	11.1	8.08	6.48	5.52	3.03	1.63
10.5V	102	65.1	53.1	30.4	19.1	10.9	8.02	6.43	5.48	3.01	1.62
10.8V	96.2	61.4	50.3	29.3	18.5	10.6	7.78	6.24	5.32	2.95	1.59

Note: The above characteristics data can be obtained within three charge/discharge cycles.

**Discharge Characteristics(25°C)**

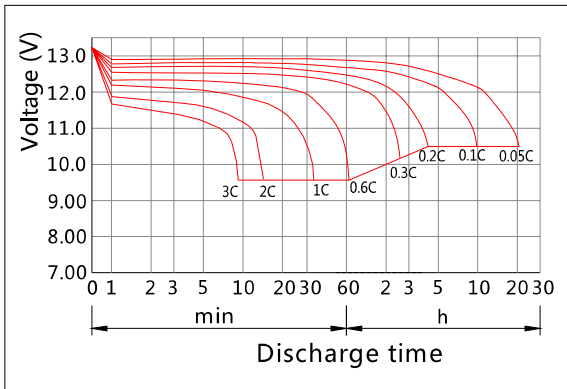

**Charging Characteristics(25°C)**

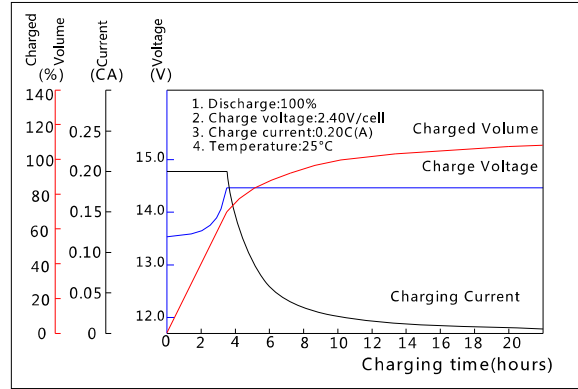

**Effect of Temperature on Capacity**

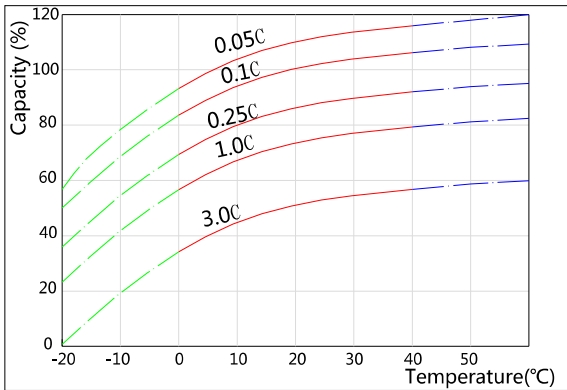

**Self-discharge Characteristics**

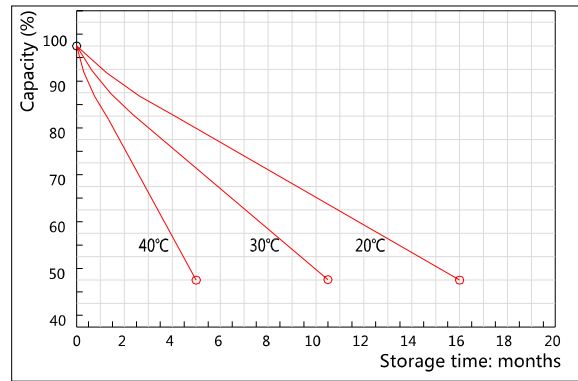

**The Relationship for Open Circuit Voltage and Residual Capacity (25°C)**

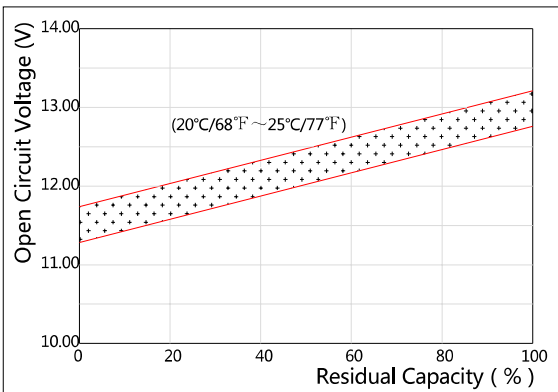

**The Relationship for Charging Voltage and Temperature**

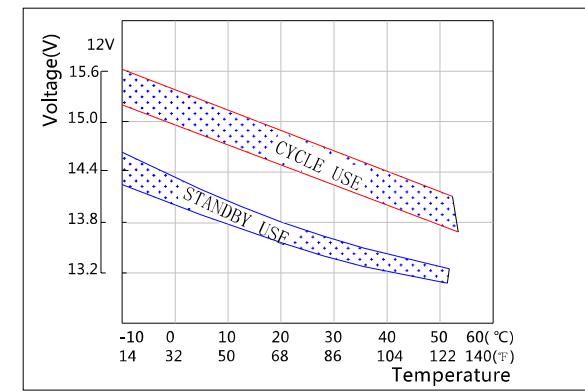

**Floating Life on Temperature**

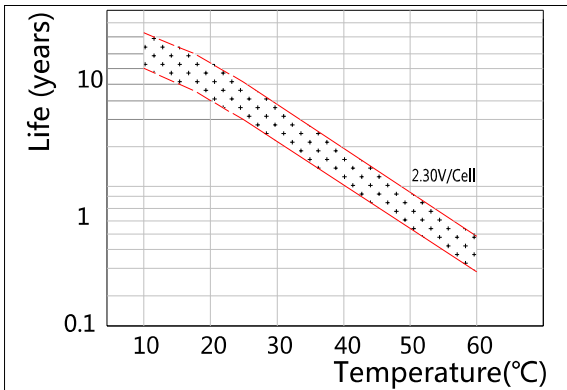

**Cycle Life on D.O.D(25°C)**

