

Specifications

Nominal Voltage		12 V
Capacity (25°C)	10HR(10.8V)	24 Ah
	5HR(10.5V)	22.2Ah
	1HR(9.60V)	16.4Ah
Dimension	Length	166 ± 2mm (6.54inch)
	Width	175 ± 2mm (6.89inch)
	Height	125 ± 2mm (4.92inch)
	Total Height	125 ± 2mm (4.92inch)
Approx. Weight		7.9kg (17.4lbs) ± 4%
Terminal type		T3/T8
Internal resistance (Fully charged, 25°C)		Approx. 14m Ω
Capacity affected by temperature (20HR)	40°C	102%
	25°C	100%
	0°C	85%
	-15°C	65%
Self-discharge (25°C)	3 month	Remaining Capacity: 91%
	6 month	Remaining Capacity: 82%
	12 month	Remaining Capacity: 65%
Nominal operating temperature		25°C ± 3°C (77°F ± 5°F)
Operating temperature range	Discharge	-15°C ~ 50°C (5°F ~ 122°F)
	Charge	-10°C ~ 50°C (14°F ~ 122°F)
	Storage	-20°C ~ 50°C (-4°F ~ 122°F)
Float charging voltage(25°C)		13.60 to 13.80V Temperature compensation: -18mV/°C
Cyclic charging voltage(25°C)		14.50 to 14.90V Temperature compensation: -30mV/°C
Maximum charging current		7.2A
Terminal material		Copper
Maximum discharge current		360A(5 sec.)
Designed floating life(20°C)		15 years

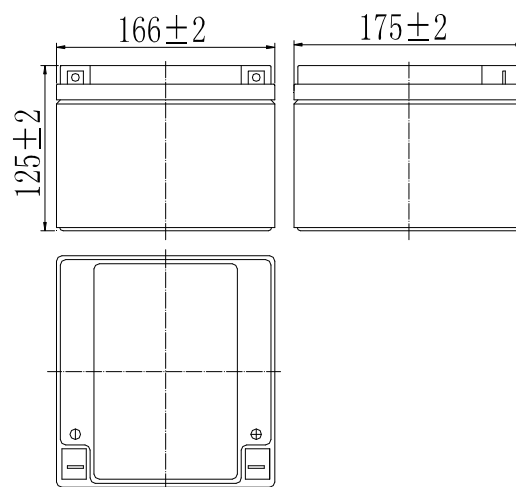

Dimensions



Terminal

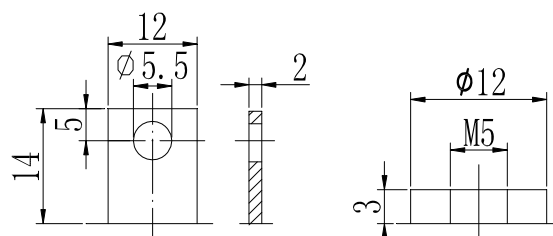

Terminal T3

Terminal T8

- ◆ Absorbent glass mat technology;
- ◆ Recognized by UL & CE;
- ◆ ABS container.

Constant Current Discharge Characteristics (A, 25°C)

F.V/TIME	10min	15min	30min	60min	2h	3h	4h	5h	8h	10h	20h
9.60V	59.7	47.8	26.6	16.4	9.31	6.68	5.35	4.54	2.93	2.48	1.28
9.90V	57.9	46.6	26.1	16.0	9.25	6.63	5.31	4.52	2.92	2.47	1.27
10.2V	55.5	44.8	25.3	15.7	9.16	6.59	5.27	4.48	2.90	2.45	1.27
10.5V	53.1	43.3	24.7	15.4	9.02	6.55	5.24	4.45	2.88	2.43	1.26
10.8V	50.2	41.0	23.8	14.8	8.79	6.35	5.08	4.32	2.79	2.39	1.24

Constant Power Discharge Characteristics (Watt, 25°C)

F.V/TIME	10min	15min	30min	60min	2h	3h	4h	5h	8h	10h	20h
9.60V	673	544	305	189	109	79.3	63.6	54.2	35.2	29.7	15.3
9.90V	653	531	299	187	108	78.9	63.3	53.9	35.0	29.6	15.3
10.2V	626	512	290	181	107	78.3	62.8	53.6	34.8	29.3	15.2
10.5V	599	494	283	178	106	77.8	62.4	53.1	34.6	29.2	15.1
10.8V	565	468	273	172	103	75.4	60.5	51.6	33.5	28.6	14.8

Note: The above characteristics data can be obtained within three charge/discharge cycles.

Discharge Characteristics(25°C)

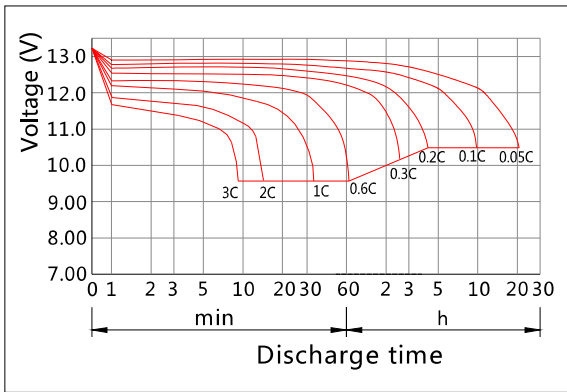

Charging Characteristics(25°C)

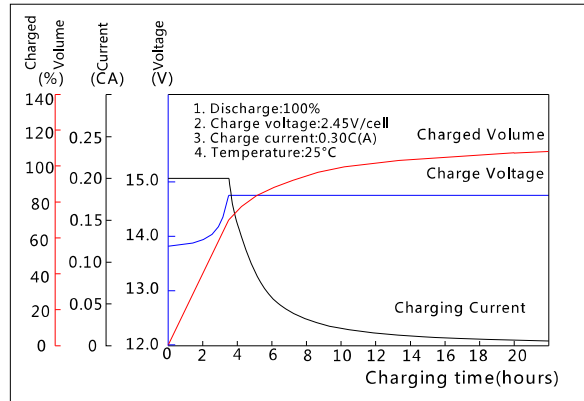

Effect of Temperature on Capacity

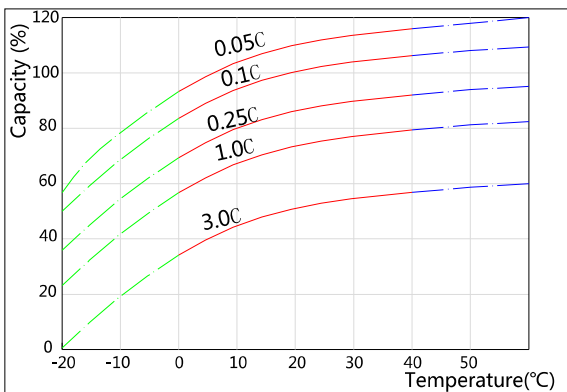

Self-discharge Characteristics

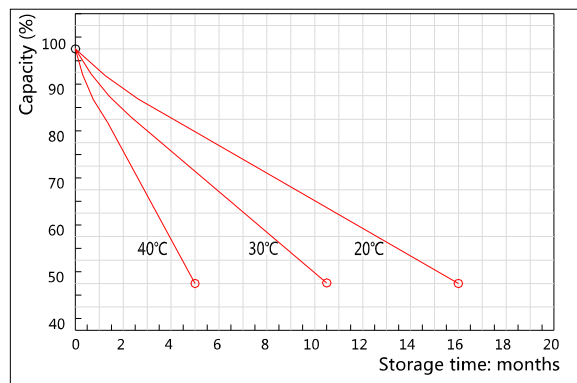

The Relationship for Open Circuit Voltage and Residual Capacity (25°C)

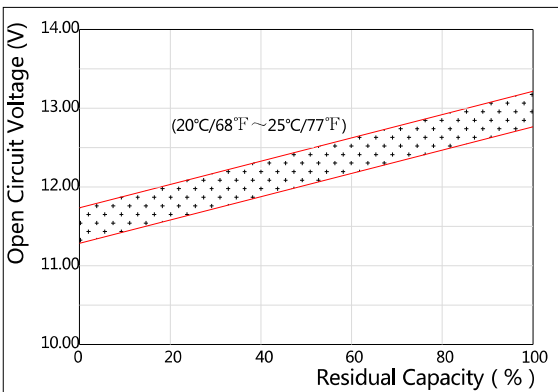

The Relationship for Charging Voltage and Temperature

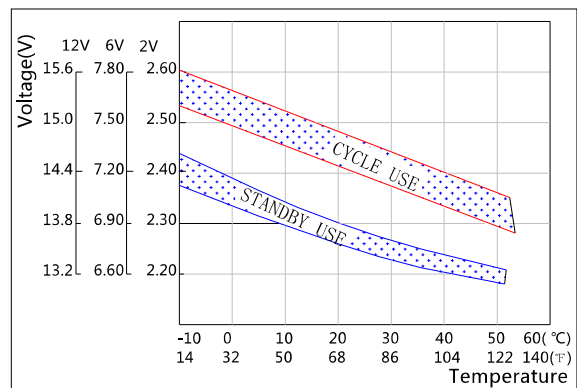

Floating Life on Temperature

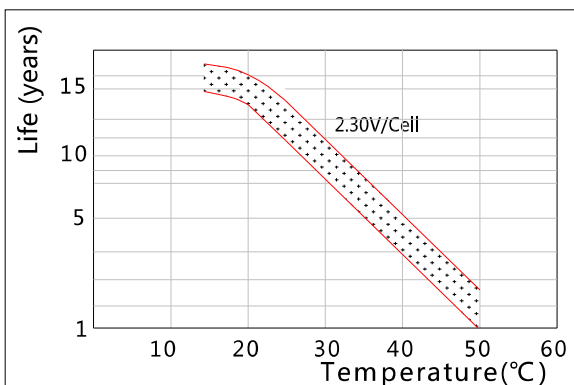

Cycle Life on D.O.D(25°C)

