

**Specifications**

Nominal Voltage		12 V
Capacity (25°C)	20HR(10.5V)	22 Ah
	10HR(10.5V)	20.5Ah
	1HR(9.60V)	14.3Ah
Dimension	Length	181 ± 2mm (7.13inch)
	Width	77 ± 1mm (3.03inch)
	Height	166 ± 2mm (6.54inch)
	Total Height	166 ± 2mm (6.54inch)
Approx. Weight		6.3kg (13.9lbs) ± 4%
Terminal type		T8
Internal resistance (Fully charged, 25°C)		Approx. 10m Ω
Capacity affected by temperature (20HR)	40°C	102%
	25°C	100%
	0°C	85%
	-15°C	65%
Self-discharge (25°C)	3 month	Remaining Capacity: 91%
	6 month	Remaining Capacity: 82%
	12 month	Remaining Capacity: 65%
Nominal operating temperature		25°C ± 3°C (77°F ± 5°F)
Operating temperature range	Discharge	-15°C ~ 50°C (5°F ~ 122°F)
	Charge	-10°C ~ 50°C (14°F ~ 122°F)
	Storage	-20°C ~ 50°C (-4°F ~ 122°F)
Float charging voltage(25°C)		13.60 to 13.80V Temperature compensation: -18mV/°C
Cyclic charging voltage(25°C)		14.50 to 14.90V Temperature compensation: -30mV/°C
Maximum charging current		6.6A
Terminal material		Copper
Maximum discharge current		330A(5 sec.)
Designed floating life(20°C)		8~10years

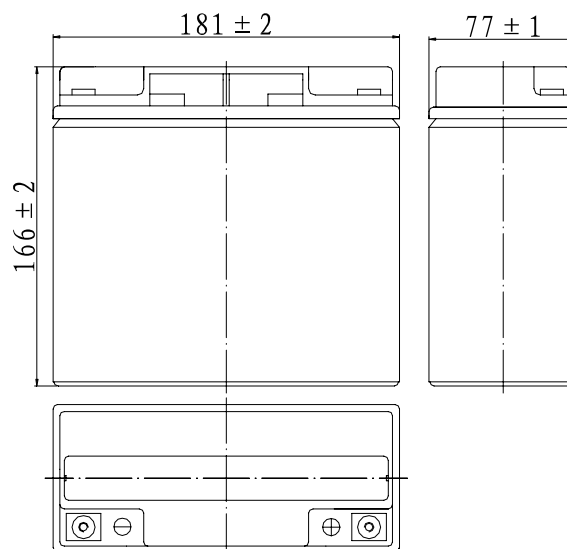

**Dimensions**



**Terminal**

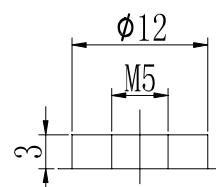

Terminal T8

- ◆ Absorbent glass mat technology;
- ◆ Recognized by UL & CE;
- ◆ ABS container.

**Constant Current Discharge Characteristics (A, 25°C)**

F.V/TIME	10min	15min	30min	60min	2h	3h	4h	5h	8h	10h	20h
9.60V	52.8	41.8	23.3	14.3	7.82	5.61	4.49	3.81	2.47	2.08	1.12
9.90V	51.2	40.8	22.9	14.1	7.77	5.58	4.46	3.79	2.45	2.07	1.11
10.2V	49.1	39.3	22.2	13.7	7.70	5.54	4.43	3.77	2.44	2.06	1.11
10.5V	47.0	38.0	21.6	13.5	7.58	5.50	4.40	3.74	2.42	2.05	1.10
10.8V	44.4	35.9	20.8	13.0	7.39	5.34	4.27	3.63	2.35	2.01	1.08

**Constant Power Discharge Characteristics (Watt, 25°C)**

F.V/TIME	10min	15min	30min	60min	2h	3h	4h	5h	8h	10h	20h
9.60V	596	477	267	166	91.4	66.6	53.5	45.5	29.6	24.9	13.4
9.90V	578	465	262	163	90.9	66.3	53.1	45.3	29.4	24.8	13.3
10.2V	554	448	254	159	90.1	65.8	52.8	45.0	29.2	24.7	13.3
10.5V	530	433	248	156	88.7	65.3	52.4	44.7	29.0	24.6	13.2
10.8V	500	410	239	151	86.5	63.4	50.8	43.3	28.2	24.1	12.9

Note: The above characteristics data can be obtained within three charge/discharge cycles.

Discharge Characteristics(25°C)

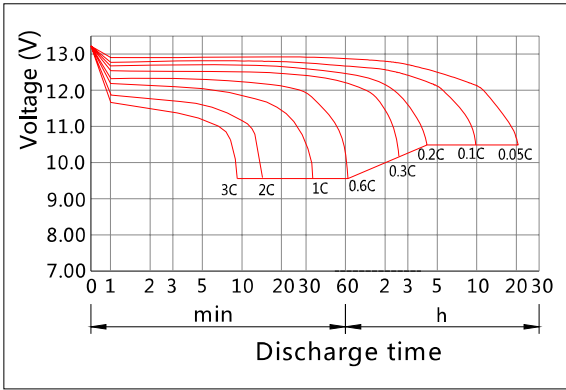

Charging Characteristics(25°C)

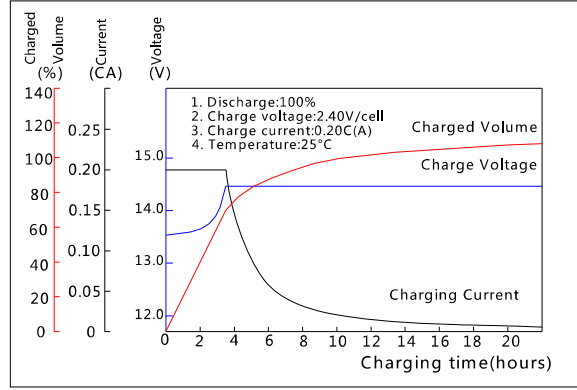

Effect of Temperature on Capacity

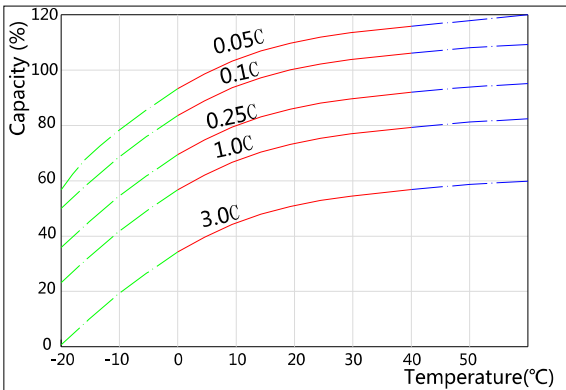

Self-discharge Characteristics

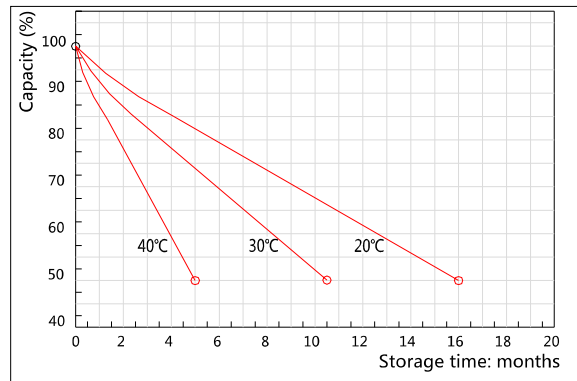

The Relationship for Open Circuit Voltage and Residual Capacity (25°C)

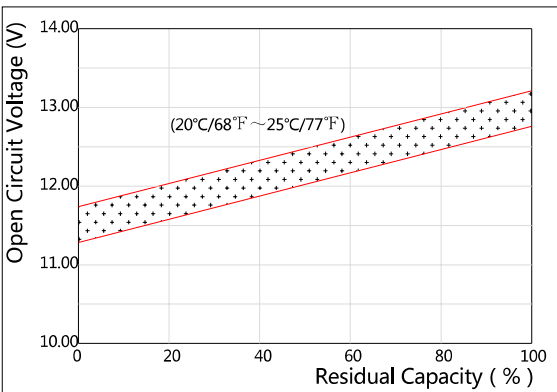

The Relationship for Charging Voltage and Temperature

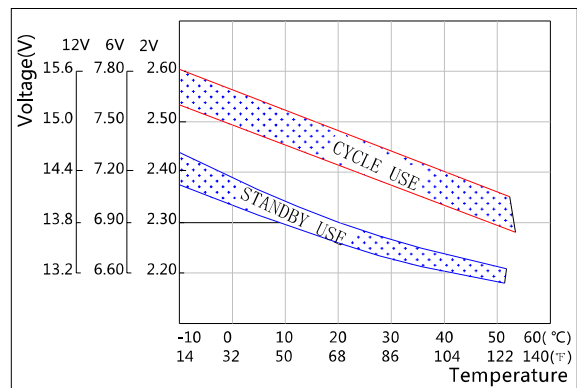

Floating Life on Temperature

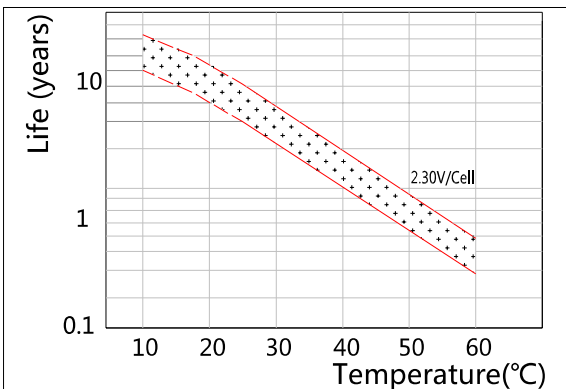

Cycle Life on D.O.D(25°C)

