

Specifications

Nominal Voltage		12 V
Capacity (25°C)	10HR(10.8V)	12Ah
	5HR(10.5V)	11.2Ah
	1HR(9.60V)	8.6Ah
Dimension	Length	151 ± 1.5mm (5.94inch)
	Width	98 ± 1mm (3.86inch)
	Height	95 ± 1mm (3.74inch)
	Total Height	101 ± 1mm (3.98inch)
Approx. Weight		3.7kg (8.16lbs) ± 5%
Terminal type		T2/T1
Internal resistance (Fully charged, 25°C)		Approx. 19m Ω
Capacity affected by temperature (20HR)	40°C	102%
	25°C	100%
	0°C	85%
	-15°C	65%
Self-discharge (25°C)	3 month	Remaining Capacity: 91%
	6 month	Remaining Capacity: 82%
	12 month	Remaining Capacity: 65%
Nominal operating temperature		25°C ± 3°C (77°F ± 5°F)
Operating temperature range	Discharge	-15°C ~ 50°C (5°F ~ 122°F)
	Charge	-10°C ~ 50°C (14°F ~ 122°F)
	Storage	-20°C ~ 50°C (-4°F ~ 122°F)
Float charging voltage(25°C)		13.60 to 13.80V Temperature compensation: -18mV/°C
Cyclic charging voltage(25°C)		14.50 to 14.90V Temperature compensation: -30mV/°C
Maximum charging current		3.6A
Terminal material		Copper
Maximum discharge current		180A(5 sec.)
Designed floating life(20°C)		15 years

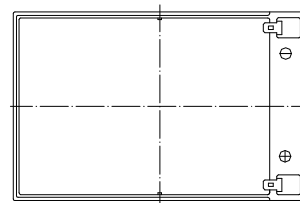

Dimensions

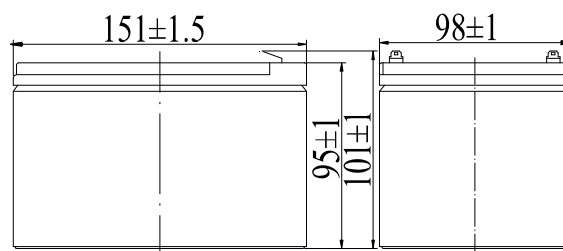

Terminal

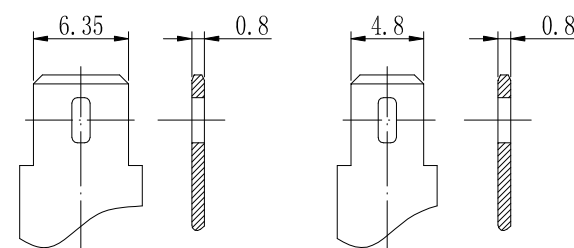

Terminal T2

Terminal T1

- ◆ Absorbent glass mat technology;
- ◆ Recognized by UL & CE;
- ◆ ABS container.

Constant Current Discharge Characteristics (A, 25°C)

F.V/TIME	10min	15min	30min	60min	2h	3h	4h	5h	8h	10h	20h
9.60V	30.7	24.6	13.8	8.59	4.69	3.37	2.70	2.29	1.49	1.24	0.65
9.90V	29.8	24.0	13.4	8.46	4.67	3.35	2.68	2.28	1.48	1.24	0.65
10.2V	28.6	23.1	13.0	8.25	4.62	3.32	2.66	2.26	1.46	1.23	0.64
10.5V	27.4	22.3	12.8	8.08	4.56	3.30	2.64	2.25	1.45	1.23	0.64
10.8V	25.9	21.1	12.2	7.83	4.44	3.20	2.57	2.18	1.41	1.20	0.63

Constant Power Discharge Characteristics (Watt, 25°C)

F.V/TIME	10min	15min	30min	60min	2h	3h	4h	5h	8h	10h	20h
9.60V	347	281	157	99.4	54.9	40.1	32.1	27.3	17.8	15.0	7.78
9.90V	337	274	154	98.0	54.6	39.7	31.9	27.2	17.7	14.9	7.75
10.2V	323	263	150	95.4	54.1	39.5	31.7	27.0	17.6	14.9	7.70
10.5V	308	254	145	93.6	53.3	39.2	31.5	26.9	17.4	14.8	7.66
10.8V	292	241	141	90.7	52.0	38.1	30.5	26.0	17.0	14.4	7.51

Note: The above characteristics data can be obtained within three charge/discharge cycles.

Discharge Characteristics(25°C)

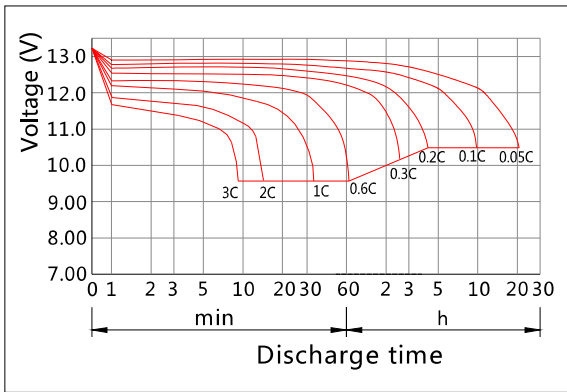

Charging Characteristics(25°C)

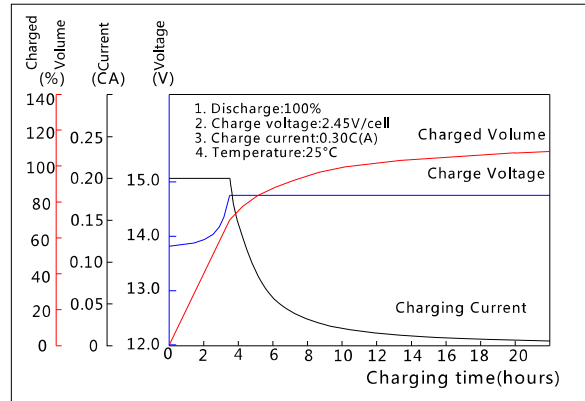

Effect of Temperature on Capacity

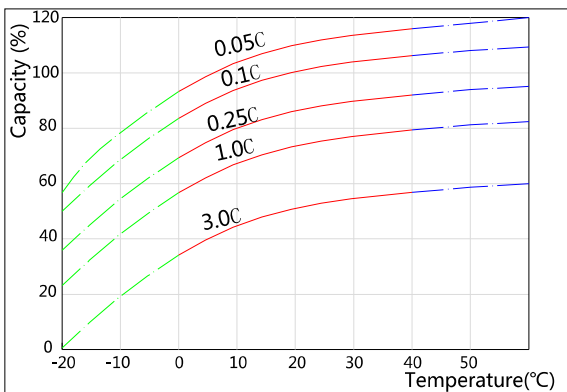

Self-discharge Characteristics

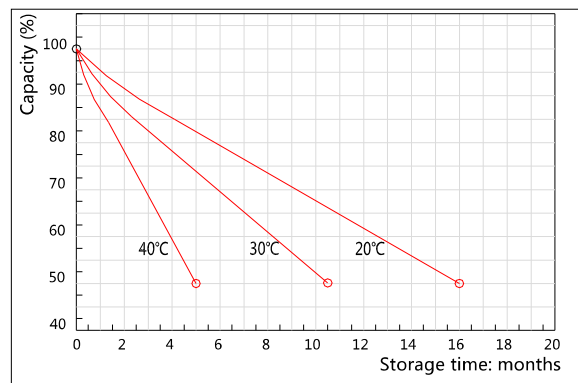

The Relationship for Open Circuit Voltage and Residual Capacity (25°C)

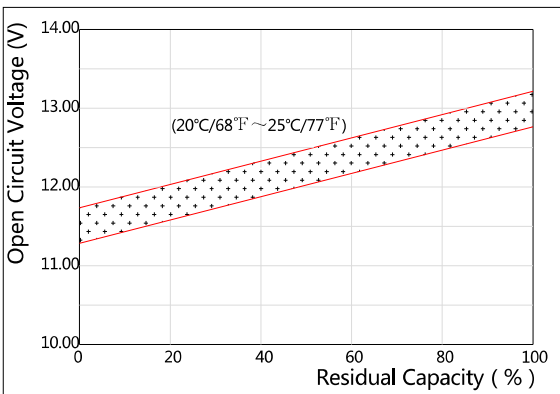

The Relationship for Charging Voltage and Temperature

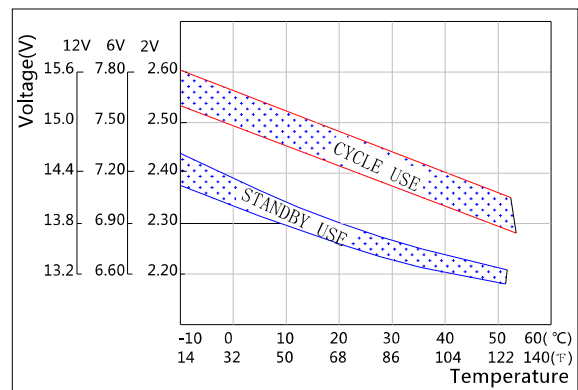

Floating Life on Temperature

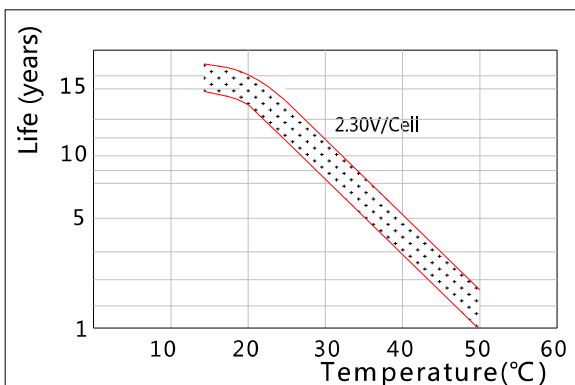

Cycle Life on D.O.D.(25°C)

