

Specifications

Nominal Voltage		2 V
Capacity (25°C)	10HR(1.80V)	1200 Ah
	3HR(1.75V)	918Ah
	1HR(1.75V)	678Ah
Dimension	Length	475 ± 2mm (18.70inch)
	Width	175 ± 2mm (6.89inch)
	Height	330 ± 2mm (12.99inch)
	Total Height	367 ± 2mm (14.45inch)
Approx. Weight		66kg (145.6lbs) ± 3%
Terminal type		T10
Internal resistance (Fully charged, 25°C)		Approx. 0.25m Ω
Capacity affected by temperature (10HR)	40°C	102%
	25°C	100%
	0°C	85%
	-15°C	65%
Self-discharge (25°C)	3 month	Remaining Capacity: 91%
	6 month	Remaining Capacity: 82%
	12 month	Remaining Capacity: 65%
Nominal operating temperature		25°C ± 3°C (77°F ± 5°F)
Operating temperature range	Discharge	-15°C ~ 50°C (5°F ~ 122°F)
	Charge	-10°C ~ 50°C (14°F ~ 122°F)
	Storage	-20°C ~ 50°C (-4°F ~ 122°F)
Float charging voltage(25°C)		2.25 to 2.30V Temperature compensation: -3mV/°C
Cyclic charging voltage(25°C)		2.42 to 2.48V Temperature compensation: -5mV/°C
Maximum charging current		240A
Terminal material		Copper
Maximum discharge current		8500A(5 sec.)
Designed floating life(20°C)		20 years

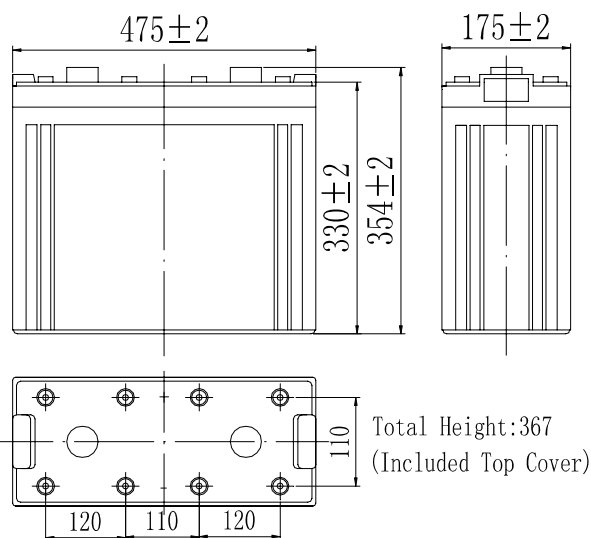

Dimensions



Terminal

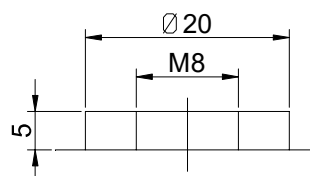

Terminal T10

- ◆ Absorbent glass mat technology;
- ◆ Recognized by UL & CE;
- ◆ ABS container.

Constant Current Discharge Characteristics (A, 25°C)

F.V/TIME	15min	30min	60min	2h	3h	4h	5h	6h	8h	10h	20h	24h
1.60V	1620	1080	720	438	312	251	218	187	147	122	64.1	55.6
1.65V	1581	1058	709	436	310	249	217	186	146	122	64.0	55.5
1.70V	1523	1026	691	432	308	248	215	185	145	122	63.8	55.3
1.75V	1471	1001	678	426	306	246	214	184	144	121	63.4	55.0
1.80V	1393	964	657	415	297	239	207	178	140	120	63.0	54.6

Constant Power Discharge Characteristics (Watt, 25°C)

F.V/TIME	15min	30min	60min	2h	3h	4h	5h	6h	8h	10h	20h	24h
1.60V	2965	2020	1368	846	612	492	429	369	292	243	128	112
1.65V	2893	1979	1347	841	608	489	427	367	291	243	128	112
1.70V	2787	1919	1313	834	604	486	424	364	289	242	128	111
1.75V	2692	1872	1287	821	600	482	421	362	287	240	127	111
1.80V	2550	1804	1248	800	582	468	408	351	278	239	126	110

Note: The above characteristics data can be obtained within three charge/discharge cycles.

Discharge Characteristics(25°C)

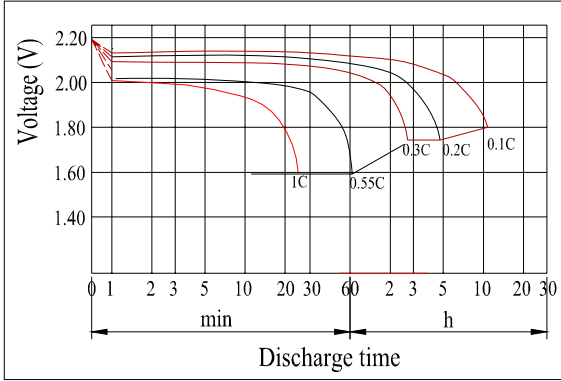

Charging Characteristics(25°C)

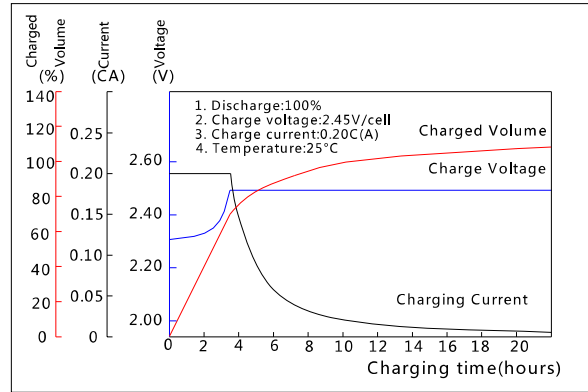

Effect of Temperature on Capacity

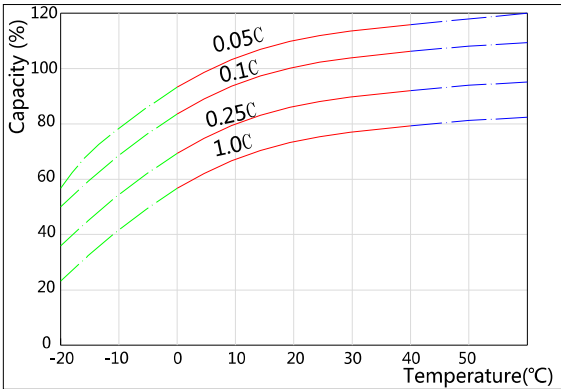

Self-discharge Characteristics

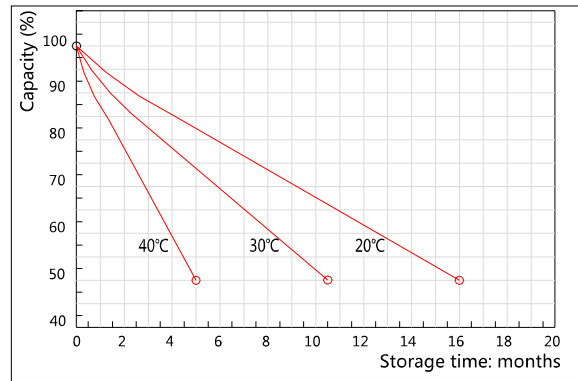

The Relationship for Open Circuit Voltage and Residual Capacity (25°C)

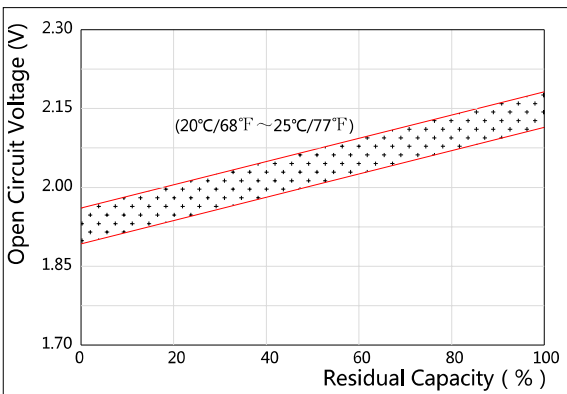

The Relationship for Charging Voltage and Temperature

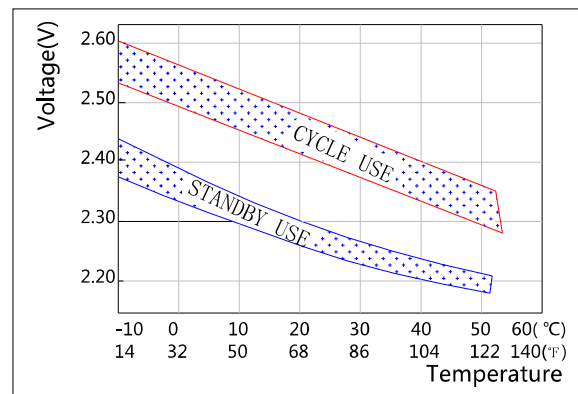

Floating Life on Temperature

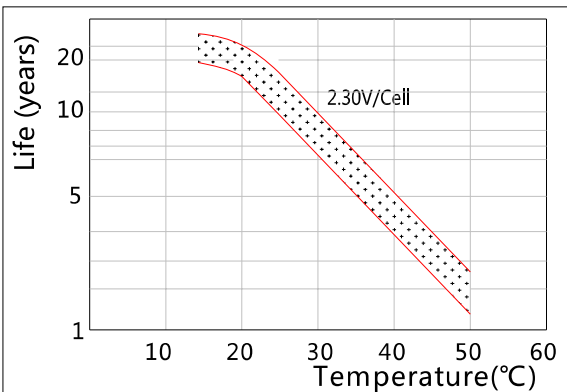

Cycle Life on D.O.D(25°C)

